

TOWNSHIP OF FOUNTAIN PRAIRIE

PREPARED BY THE
MINNESOTA DEPARTMENT OF TRANSPORTATION
OFFICE OF TRANSPORTATION SYSTEM MANAGEMENT

IN COOPERATION WITH
U.S. DEPARTMENT OF TRANSPORTATION
FEDERAL HIGHWAY ADMINISTRATION



1 in = 1,600 ft

2023

Projection:
Transverse Mercator
NAD 1986
UTM Zone 15

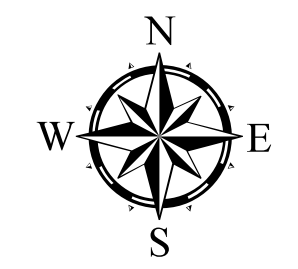

North American Datum
of 1986

ROAD AND ROADWAY FEATURES		BOUNDARY FEATURES	
INTERSTATE	CONCRETE	TRIBAL LAND	STATE OF MINNESOTA
US HIGHWAY	BITUMINOUS	COUNTY	MUNICIPALITY
MN HIGHWAY	GRAVEL	UNINCORPORATED	CIVIL TOWNSHIP
COUNTY STATE AID HIGHWAY	DIRT/UNIMPROVED	SECTION	MILITARY
COUNTY ROAD	OTHER	VOYAGEURS NATIONAL PARK	BOUNDRARY WATERS CANOE AREA WILDERNESS
TOWNSHIP ROAD	UNKNOWN	STATE PARK	REGIONAL PARK
UNORGANIZED TERRITORY ROAD		NATIONAL FOREST	NATIONAL AND STATE FOREST
OTHER ROADS		STATE FOREST	WILDLIFE REFUGUE AREA
Municipal		WILDLIFE MANAGEMENT AREA	HYDROLOGIC FEATURES
Private		NATIONAL TRAIL	RIVER OR STREAM (PERMANENT)
National Monument		WILDLIFE REFUGUE AREA	LAKE, POND OR RESERVOIR
National Wildlife		WILDLIFE MANAGEMENT AREA	STREAM (INTERMITTENT)
State Game		HYDROLOGIC FEATURES	DRAINAGE DITCH
State Park		RIVER OR STREAM (PERMANENT)	WETLAND
Preserve		LAKE, POND OR RESERVOIR	ISLAND OR LAND
		STREAM (INTERMITTENT)	REGIONAL WATERSHED
		DRAINAGE DITCH	
		WETLAND	
		ISLAND OR LAND	
		REGIONAL WATERSHED	

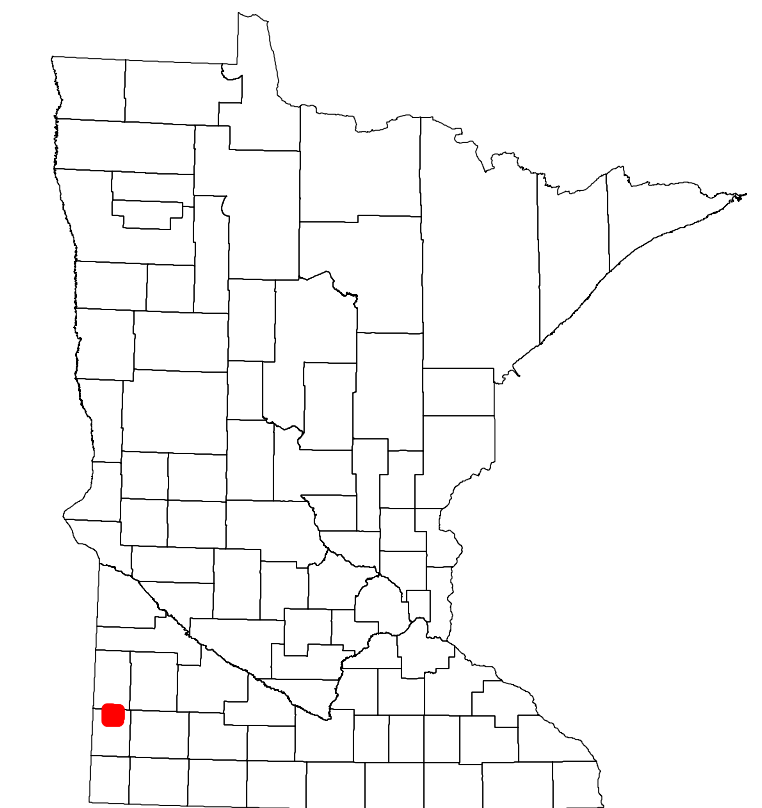

Population (U.S. Census 2010): 188

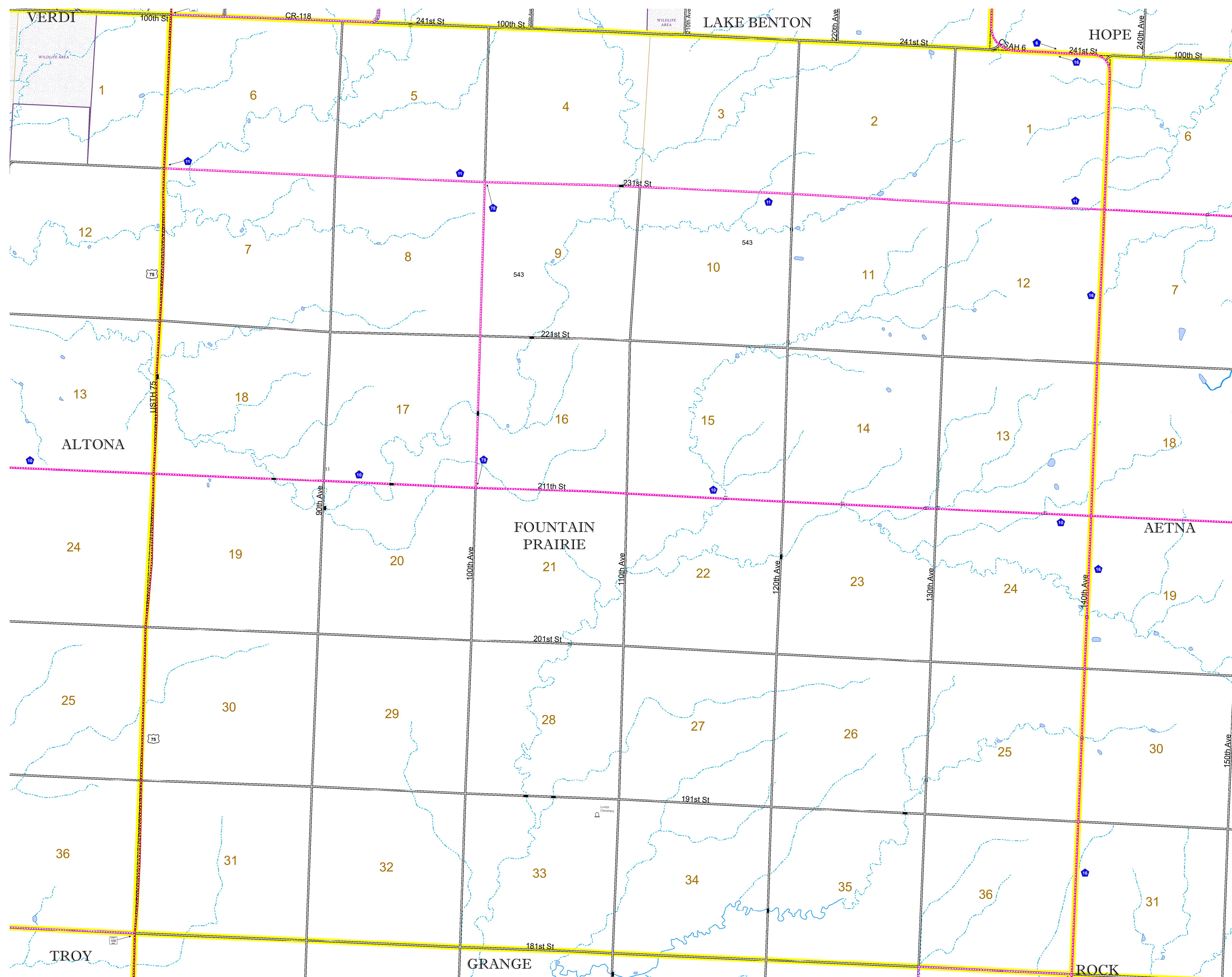

To request information from this document in an alternative format, call 651-366-4718 or 1-800-657-3774 (Greater Minnesota); 711 or 1-800-627-3529 (Minnesota Relay). You may also send an e-mail to ADRequest.dot@state.mn.us. (Please request at least one week in advance.)