

Sample Plan

REMOVAL PLAN ----- NARRATIVE

References:

- Design Scene: Chapter 8 - Inplace Topography and Removals
- Technical Memorandum: 17-04-ENV-02 Tree Clearing Timing Requirement
- Miscellaneous:
 - "Salvage Materials" from Maintenance Superintendents, most recent date
 - <http://www.dot.state.mn.us/environment/regulatematerials/Index.html> Waste Handling and Approved End Sites
 - <http://hub.metro/design/technicalguidance.html> Salvage Materials Contact List
 - <http://hub.metro/design/technicalguidance.html> Noxious Weeds

General Information:

When separate removal plan sheets are necessary, modify an Inplace topography sheet.

Use a pattern to designate the items to be removed. Include a legend to identify the patterns.

Any removals and/or salvaged items, whether shown on these sheets or not, should be included in the removal tabulation unless tabulated somewhere else in the plan.

To reduce clutter, consider not showing items from the plan sheets that don't relate to the removals, e.g. Inplace utilities.

Items to be salvaged should be identified on the Removal Sheets. Contact Maintenance regarding salvageable items determining if items are to be hauled away. If so, this is not eligible for Federal funds.

Show R/W lines.

Building removals may be shown on this sheet. For an example of a building removal tab, see Special Environmental Plan narrative.

All removals not shown on these sheets should be cross-referenced and shown on other sheets.

Show stations for sawcuts. Also show offsets unless sheet becomes too cluttered.

It is recommended that construction limits be shown unless the sheets would become too cluttered. If removals determine the construction limits in particular areas, show those construction limits.

When environmental issues are a concern (such as wetlands, trees, shrubs, etc.) temporary fencing should be used during construction. Show noxious weed areas that must be treated or quarantined.

The Designer should make sure removal patterns are distinctive.

Clearance above a proposed structure such as noise walls as related to existing trees should be addressed with Tree Pruning.

Sample Plan

REMOVAL PLAN ----- CHECKLIST

- 1. North arrow
- 2. Legend
- 3. Bar Scale
- 4. R/W Lines
- 5. Noxious weed areas
- 6. Roadways labelled
- 7. Areas of Environmental Sensitivity
- 8. Cross references to other sheets (as applicable)
- 9. Drawn by: and Checked by: Initials and Engineer's signature

REVISION DATE 05/14/19
 PLOTTED/REVISED: 23-OCT-2019

LEGEND

	CLEAR AND GRUB (ACRE)		REMOVE CONCRETE WALK
	CLEAR AND GRUB (TREE)		REMOVE PAVEMENT
	REMOVE CURB AND GUTTER		REMOVE CONCRETE DRIVEWAY PAVEMENT
	REMOVE CHAIN LINK FENCE		REMOVE BITUMINOUS PAVEMENT
	REMOVE GUARDRAIL-PLATEBEAM		TEMPORARY FENCE (LIN FT)
	REMOVE CONCRETE MEDIAN BARRIER		TEMPORARY FENCE (SINGLE TREE)
	REMOVE GAS MAIN		
	REMOVE NOISE WALL		
	SAWING CONCRETE PAVEMENT (FULL DEPTH)		
	SAWING BITUMINOUS PAVEMENT (FULL DEPTH)		
	REMOVE WOOD NOISE WALL		

SAMPLE PLAN

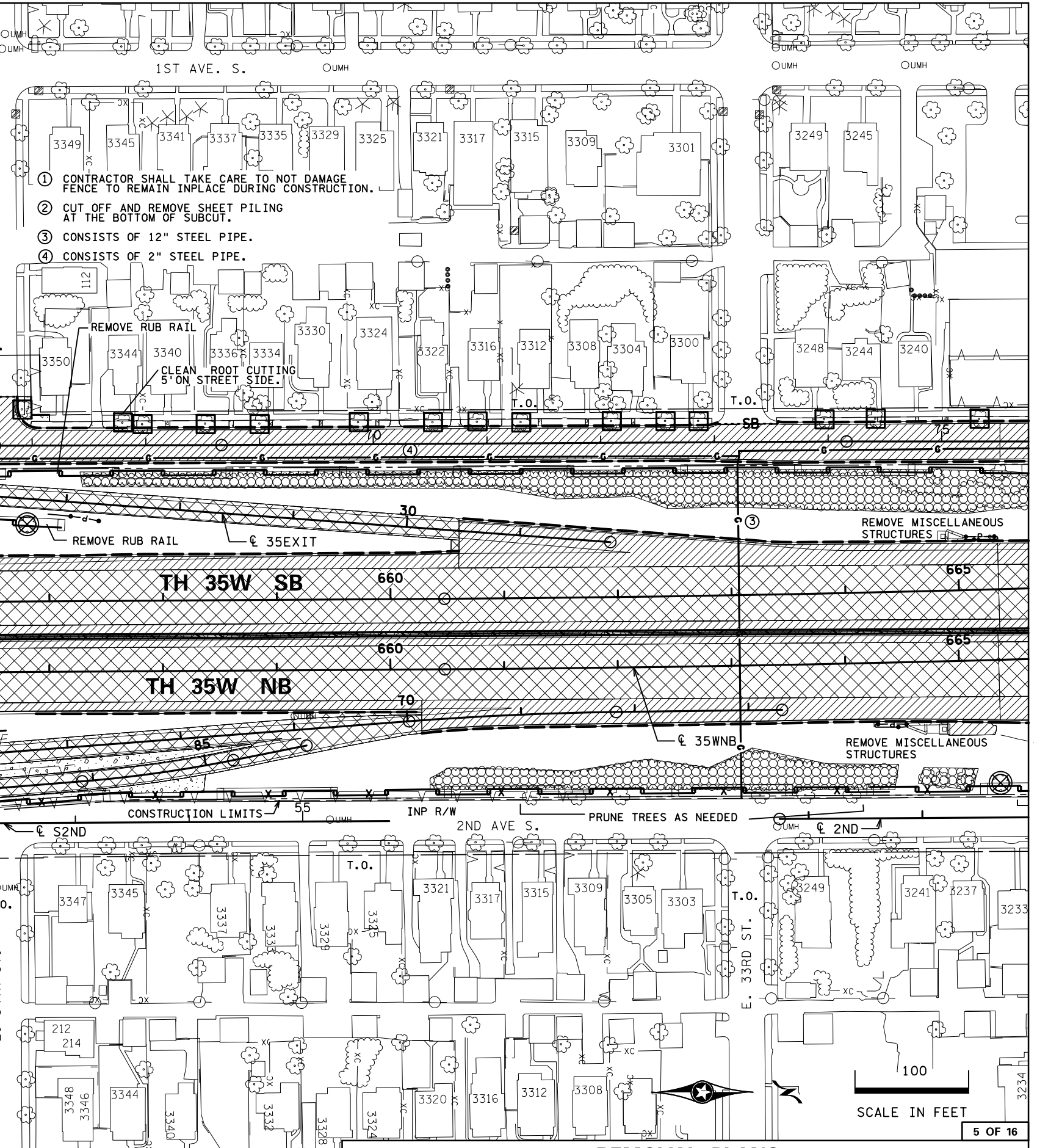

DISTRICT #: Metro
 I/PLOT NAME: Inpreno
 FILENAME: Project\DM_R05\Win_Proj\Design\SamplePlan\English\Inpreno.dgn

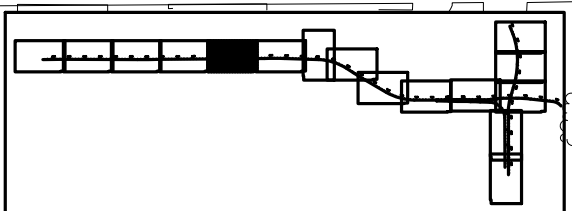

100
 SCALE IN FEET