

PREPARED BY  
HIGHWAY PLANNING SURVEY  
IN COOPERATION WITH  
U. S. PUBLIC ROADS ADMINISTRATION

STATE OF MINNESOTA  
DEPARTMENT OF HIGHWAYS  
ROAD LIFE STUDIES  
CONSTRUCTION PROJECT LOG RECORD

CONTROL SECTION 0404  
TRUNK HIGHWAY  
COUNTY Beltrami  
DISTRICT 2A

LIMITS: South Jct. T.H. 89 - W. Jct. T.H. 72

Red Lake Indian Reservation

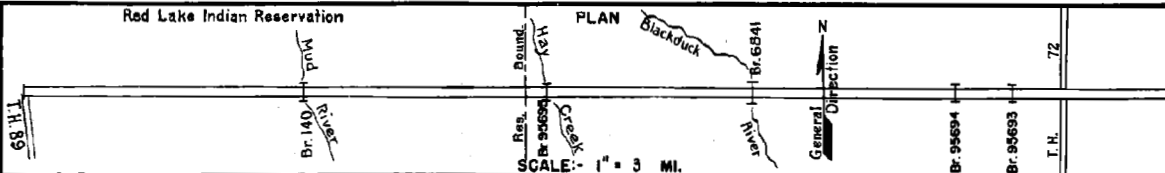

YEAR BUILT	PROJECT N°	DESCRIPTION		REMARKS	CODE N°
		TYPE	WIDTH THICKNESS		
		Gravel	20' 2"	No Record of Constr. Added in 1934.	D157
		Br. N 140 & 424	20' 2"	16' W.S. - 14' W.S.	
		Earth	20'	No Record of Constr.	
		Br. N 423, 2671	22'	14' W.S. 92' B.S.	
		564 & 563	22'	14' W.S. & 14' W.S.	
1938	A.F.E. 21	Grading	28'		1238
				Maint. Dept.	
1938	I-160-25	Grading	28'	Work done by Red Lake Indian Service.	
		Gravel	24' 2"		
		Br. 140	(1)		
C					
1940	A.F.E. 30	Bit. Surf. Treat.	27' 3/4"		
				Maint. Dept.	
C					
1941	A.F.E. 25	Gravel	20'	402 C.Y./Mi.	
				Maint. Dept.	
M					
1942	A.F.E. 4	Bit. Retreat	28'	RT-5, 6169 Gal./Mi. Grav. 344 C.Y./Mi.	
				Maint. Dept.	
M					
1944	A.F.E. 5	Bit. Seal Coat		RT-5, 2832 Gal./Mi. Grav. 97 C.Y./Mi.	
				Maint. Div.	
C					
1945	A.F.E. 6	Grav. Surfacing	20' 2"	819 C.Y./Mi.	
				Maint. Div.	
M					
1947	A.F.E. 6	Grav. Resurfacing	20'	1485 C.Y.	
C					
1947	A.F.E. 21	Heavy Reshaping	28'		
C					
A.F.E. 27		Bit. Surfacing (174M)	28'	1 3/4" MC3 & 503, 6966 Gal.	
1948	A.F.E. 26	Bit. Resurfac. (6.36M)	24'	1" Agg. 7058 Tons	
		Mixed Bit.		added	
C&M					
A.F.E. 28 & 29		Regrading	28'		
1948	A.F.E. 6	Grav. Surfacing (120M)	28'	14,106 Tons	1048
		Grav. Resurf. (66M)			
M					
1950	A.F.E. 4	Bit. Fog Seal	24'	RCS-1, 12885 Gal. Agg. 912 C.Y.	

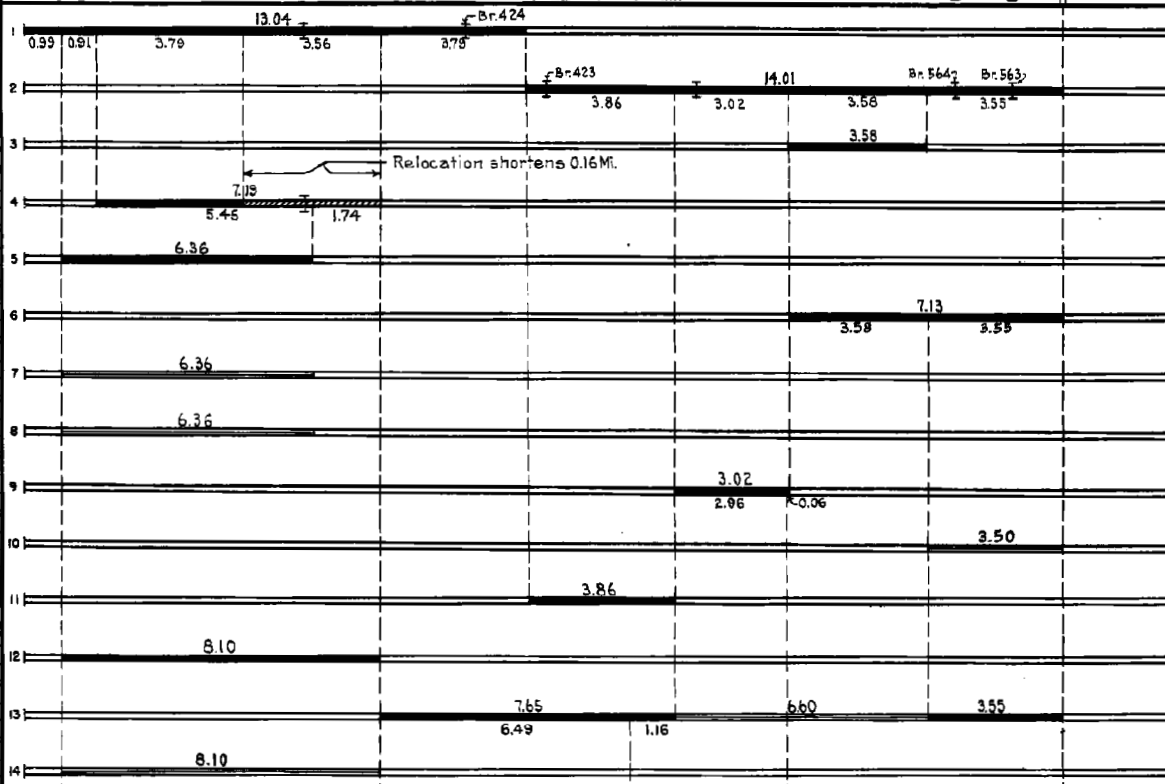

YEARS		TOTAL MILES	UNINCORPORATED		INCORPORATED		RURAL		URBAN	
FROM	TO		RDWY. MI.	BR. MI.	RDWY. MI.	BR. MI.	RDWY. MI.	BR. MI.	RDWY. MI.	BR. MI.
1934	1937	27.05	27.02	0.03	0.00	0.00	27.02	0.03	0.00	0.00
1934	1954	25.89	26.86	0.03	0.00	0.00	26.86	0.03	0.00	0.00
1955	1955	25.32	25.28	0.04	0.00	0.00	25.28	0.04	0.00	0.00
1956	1958	24.90	24.86	0.04	0.00	0.00	24.86	0.04	0.00	0.00
1959		24.37	24.33	0.04	0.00	0.00	24.33	0.04	0.00	0.00

REMARKS: Layout is to scale as of 1934

(1) Old wood span replaced by 12' x 6' x 32' Conc. Arch.

PREPARED BY  
HIGHWAY PLANNING SURVEY  
IN COOPERATION WITH  
U.S. PUBLIC ROADS ADMINISTRATION

STATE OF MINNESOTA  
DEPARTMENT OF HIGHWAYS  
ROAD LIFE STUDIES  
CONSTRUCTION PROJECT LOG RECORD

CONTROL SECTION 0404  
TRUNK HIGHWAY 1  
COUNTY Beltrami  
DISTRICT 2A

LIMITS: S. Jct. T.H. 89 to W. Jct. T.H. 72

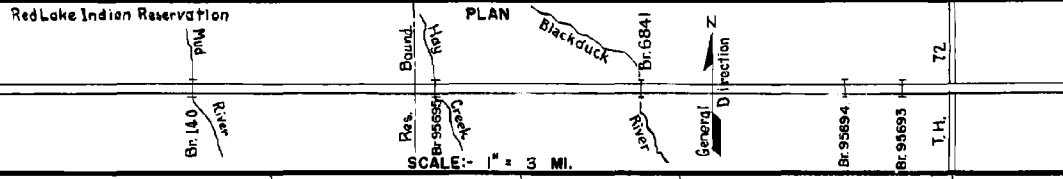

YEAR BUILT	PROJECT N <sup>o</sup>	DESCRIPTION			CODE N <sup>o</sup> DIST
		TYPE	WIDTH	THICKNESS	
C	1990 A.F.E. 30	Clean Ditches & Constr. Offtake Ditch			
C	1990 A.F.E. 29	Remove old Culv. & Install 2-C.M. Culvb Restore Bit. Surf.			MC-5 1100 Gals. Agg. 96 C.Y.
M	1990 A.F.E. 6	Gravel Resurfacing			7662 Tons
C	1951 1950 A.F.E. 38 1951 A.F.E. 36	Channel Change Install Culvert Br. 424			15'x9'7'x80' Multi-Plate Arch. 3651
C	1971 A.F.E. 39	Install Culvert			2-19'x48' Culv. & 2 Drop Inlets
C	1971 A.F.E. 29	Rip, Rap & Sod Install 2 Culverts			24' 36" x 48" Culv.
M	1971 A.F.E. 4	Bit. Surf. Repair	40'		MC-3 3450 Gal. Agg. 188 C.Y.
C	1952 0404-03 A.F.E. 3029 & 28	Br. 6795, 6794 & 6793 Approaches to Bridges	28'		3-20' B.S. 252
M	1954 A.F.E. 605	Light Bit. Seal	24'		RCS-1, 13691 Gal. Agg. 495 C.Y.
C	1955 0404-05 0404-06	Grading Gravel Br. 6841	34' 24' 30'	2 3/8"	9" Selected Sand 1200 C.Y./MI. 154 135' B.S. 254
M	1955 A.F.E. 606	Grav. Resurfacing	24'		3436 Tons
C	1956 0403-02 A.F.E. 823	Grading Select Gran. Mat. Mixed Bit. (Mixed P.)	36' 36' 30'	12" 1 1/2"	MC-2 2300 Gal. Agg. 1 1/2 x 3/8' Grav. 154
C	1948 A.F.E. 25	Mixed Bit.	24'	1"	Transferred into T.H. System in 1956 from East Leg T.H. 89
C	1957 A.F.E. 819	Bit. Resurfacing Mixed Bit.	24'	1" added	MC-2 83628 Gal. Agg. 6247 Tons
C	1958 A.F.E. 823	Spot Base & Sub-base Bit. Surfacing Mixed Bit.	24'	1"	SC-3 127648 Gal. Agg. 6138 Tons 1558

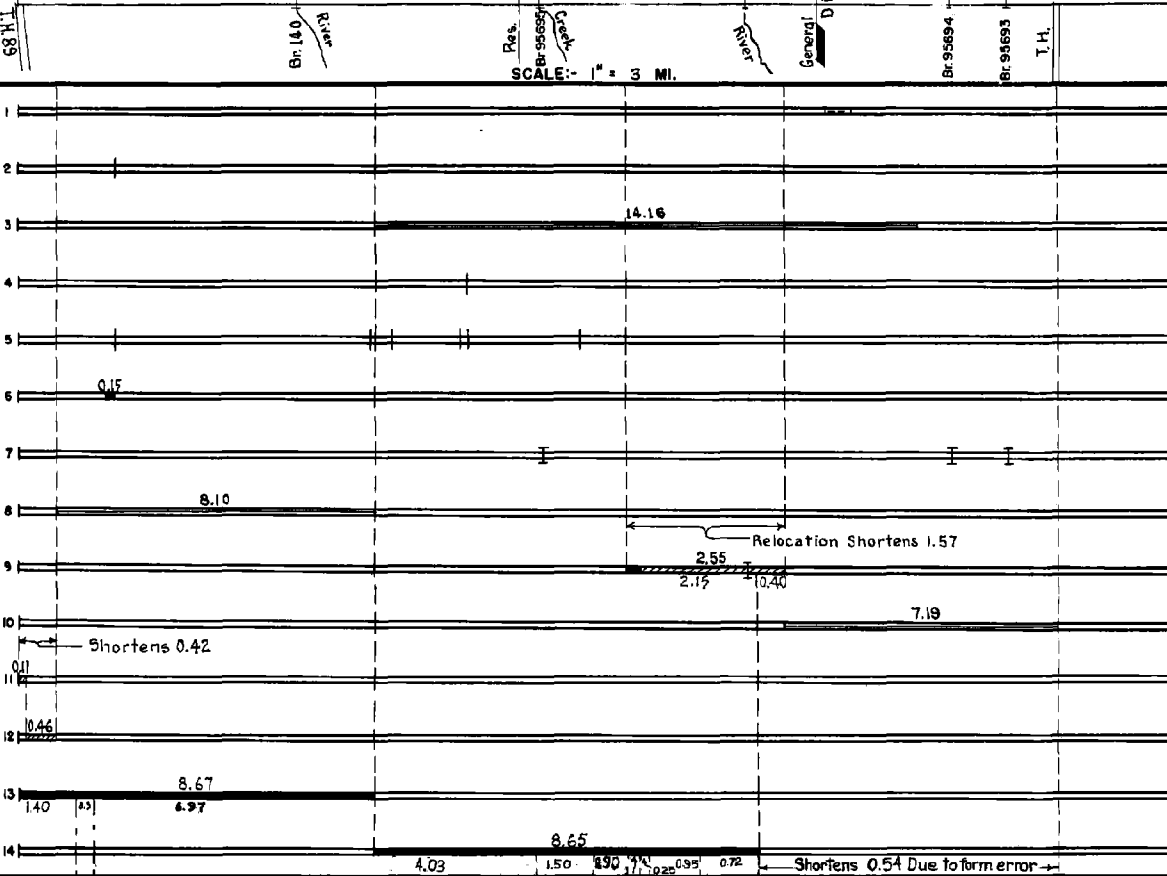

YEARS FROM	TOTAL MILES TO	UNINCORPORATED		INCORPORATED		RURAL		URBAN		REMARKS: See Sheet No. 1
		RDWY. MI.	BR. MI.	RDWY. MI.	BR. MI.	RDWY. MI.	BR. MI.	RDWY. MI.	BR. MI.	

REMARKS: See Sheet No. 1

PREPARED BY  
TRAFFIC AND PLANNING DIVISION  
IN COOPERATION WITH  
U.S. DEPARTMENT OF COMMERCE  
BUREAU OF PUBLIC ROADS

STATE OF MINNESOTA  
DEPARTMENT OF HIGHWAYS  
ROAD LIFE STUDIES  
CONSTRUCTION PROJECT LOG RECORD

CONTROL SECTION 0404  
TRUNK HIGHWAY 1  
COUNTY Beltrami  
DISTRICT 2A

LIMITS: S. Jct. T.H. 89 - N. Jct. T.H. 72

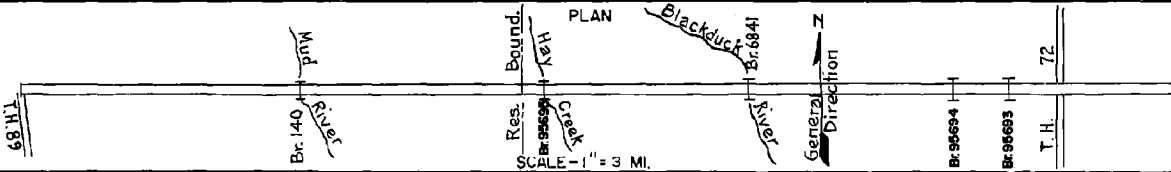

Dist. No.	YEAR BUILT	PROJECT NO	DESCRIPTION			REMARKS
			TYPE	WIDTH	THICKNESS	
1859	1959	A.F.E. 819	Grading Base			67122 Tons Grav. Base
			Bit. Surface	24'	1"	503,660.76 Gal.
			Light Bit. Seal	25'		RC-2, 30,007 Gal.
1660	1960	M	Light Bit. Seal	25'		RC-2, 11,508 Gal. Agg. 448 C.Y.
			(Shoulders)			
1163	1963	SF	Grada & Gravel Seeding	10'	2"	5' Rt & Lt.
			Spot Treat.			MC-2, 9,002.3 Gal.
	1964	SF	Bit. Surf. Repair	24'		Agg. 9590 Y&S 5402 Tons
			Light Bit. Seal	25'		RS-10, 4,028.0 Gal. Agg. 1395 Tons
1972	1972	SF	Plant Mix Resurfacing	24'	1 1/2"	MC-800, 558.0 Gal. MC-250-40, 952 Gal. Agg. 6,195 Ton
			Grade and Base	24'	15"	Relocation 0.11 mi.
1471	1972	0404-11	Plant Mix. Bit.	24'	1 1/2"	0.65 Mi.
			Agg. Shoulders	10'	Var.	Right & Left
1972	1972	SF	Bit. Resurface	24'	1 1/2"	
772	1972	0404-12	PLATE BEAM GUARD			1995 LIN. FT.
			RAIL BR'S 6795, 6841, 6794, 6793			
1473	1973	0414-13	PLATE BEAM GUARD			400 LIN. FT.
			RAIL BR # 140			
179	1979	0400-04	3 CABLE			1050 LIN. FT.
			GUARDRAIL			
2477	1977	SF	BIT. RESURFACE	24'	VAR.	2.3
2778	1978	SF	BIT. RESURFACE	24'	VAR.	2.7
			Bituminous Resurfacing	Var.	1 1/2"	32,781 Ton (US OIR Ton Age)
8-74	1983	0404-19	Bridge Removal			Br's 6795, 6794, 6793
			Box Culverts			95695, 95694, 95693

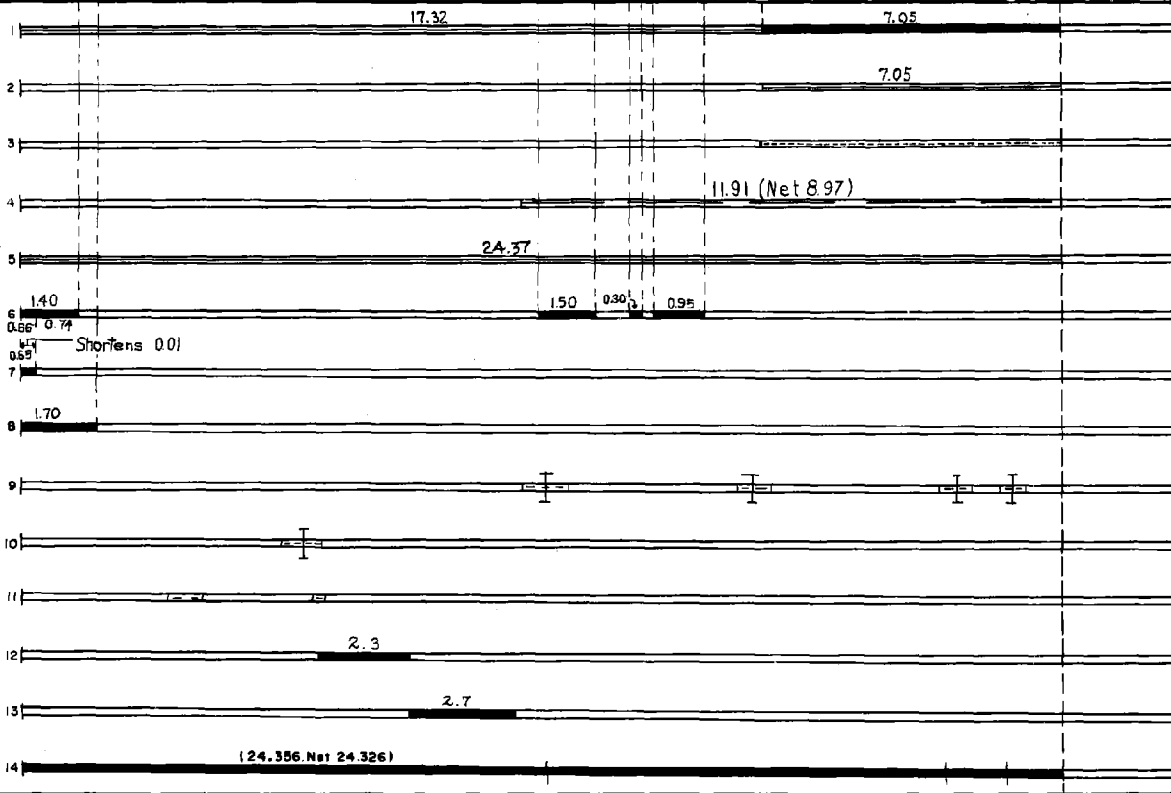

YEARS FROM	YEARS TO	TOTAL MILES	UNINCORPORATED		INCORPORATED		RURAL		URBAN	
			RDWY. MI.	BR. MI.	RDWY. MI.	BR. MI.	RDWY. MI.	BR. MI.	RDWY. MI.	BR. MI.

REMARKS: See Sheet No. 1  
FOR OTHER PROJECTS SEE DIST. NO. 2071

