

PREPARED BY
HIGHWAY PLANNING SURVEY
IN COOPERATION WITH
U.S. PUBLIC ROADS ADMINISTRATION

STATE OF MINNESOTA
DEPARTMENT OF HIGHWAYS
ROAD LIFE STUDIES
CONSTRUCTION PROJECT LOG RECORD

CONTROL SECTION 0505
TRUNK HIGHWAY 55
COUNTY Benton
DISTRICT 3B

LIMITS: Jct. T.H. 23 - E. Co. Line

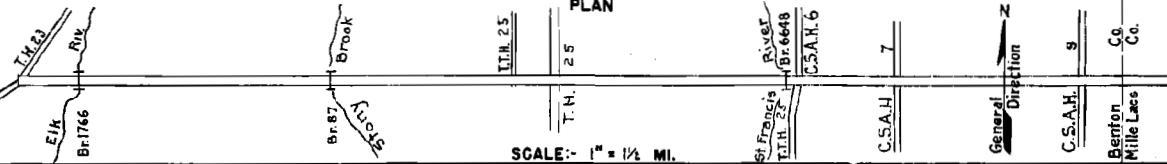

YEAR BUILT	PROJECT N ^o	DESCRIPTION			CODE N ^o
		TYPE	WIDTH	THICKNESS	
		Earth	24'		No Record of Constr. Added in 1934. 96' B.S.
		Br. N ^o 1766	16'		
		Gravel	22'	1 1/2"	No Record of Constr. Added in 1934.
1927		Gravel	22'	2 1/2"	Co. Job # 2702 Added in 1934. 1200 C.Y./Mi. 60' L.T. & 10 C.A.
1929		Gravel	22'	2 1/2"	Co. Job # 2301 Added in 1934. 1200 C.Y./Mi. 20' B.S.
1936A.F.E. 27		Reshape	28'		
1937	1937A.F.E. 46	Stab. Subgrade	24'	1"	
		Gravel	24'	2 1/4"	Maint. Dept.
		Br. 1766	27'		96 B.S. (Widen.)
		Br. 87	27'		20' B.S. (Widen.)
					Maint. Dept.
C		Grading	32'		
1940	A.F.E. 59	Gravel	26'	1 3/4"	Maint. Dept.
C					Replace Br. 1875
1941	0505-01	Culvert			C 64 X 32
M		Culy. Inst.			
1947	A.F.E. 22	Reshaping (Spots)			1019 C.Y./Mi.
	A.F.E. 6	Regrav. & Lifts			Maint. Dept.
C		Sand-Grav. Base	29'	6-12"	5C-3, 6522 Gal.
1947	A.F.E. 33	Bit. Surf. Repair (Mixed Prime)	26'		Upper 2 of Gravel. Stab. with Bit.
M		Spot Treat.			5C-3, 4544 Gal.
1948	A.F.E. 4	Bit. Surf. Repair	24'		Agg. 310 C.Y.
C		Grading	30 3/4'		
1949	0505-03	Stab. Gravel	30'	1 1/2"	C 64 X 40 Culv.
	0505-04	Br. 6648	30'		60 C.D.G.
M					MC-3, 898 Gal.
1950	A.F.E. 4	Bit. Surf. Repair	24'		Agg. 64 C.Y.
C		Stab. Grav. Base	28'	3-8"	
1950	0505-07	Plant Mix Bit.	24'	1 1/2"	

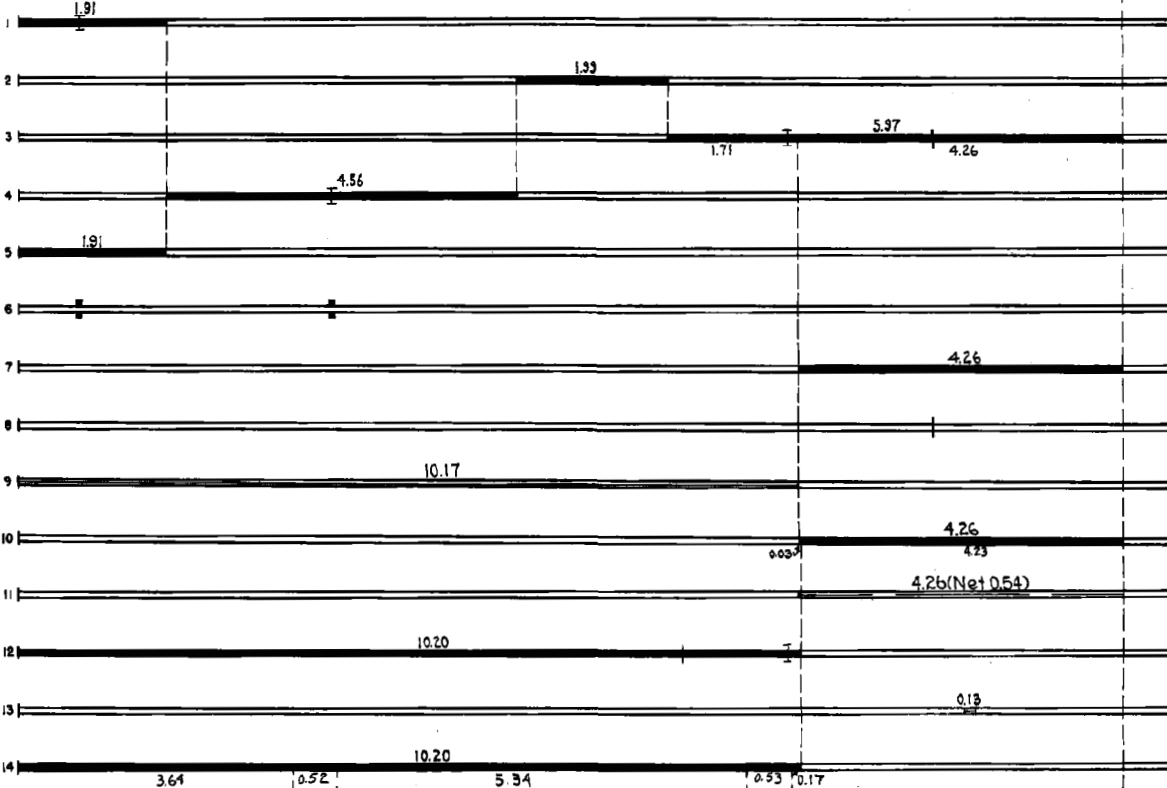

YEARS FROM	TO	TOTAL MILES	UNINCORPORATED		INCORPORATED		RURAL		URBAN	
			RDWY. MI.	BR. MI.	RDWY. MI.	BR. MI.	RDWY. MI.	BR. MI.	RDWY. MI.	BR. MI.
1934		14.43	14.40	0.03	0.00	0.00	14.40	0.03	0.00	0.00

REMARKS: Layout is to scale as of 1934

PREPARED BY
 BUREAU OF POLICY & PLANNING
 IN COOPERATION WITH
 U. S. DEPARTMENT OF TRANSPORTATION - FEDERAL HIGHWAY ADMINISTRATION

STATE OF MINNESOTA
 DEPARTMENT OF TRANSPORTATION
 CONSTRUCTION PROJECT LOG RECORD

CONTROL SECTION 0505
 TRUNK HIGHWAY 95
 COUNTY Benton
 DISTRICT 3B

LIMITS: Jct. MNTH 23 - Benton/Mille Lacs Co. Line
 Ref. Pt. 000+00.050 - 014+00.424

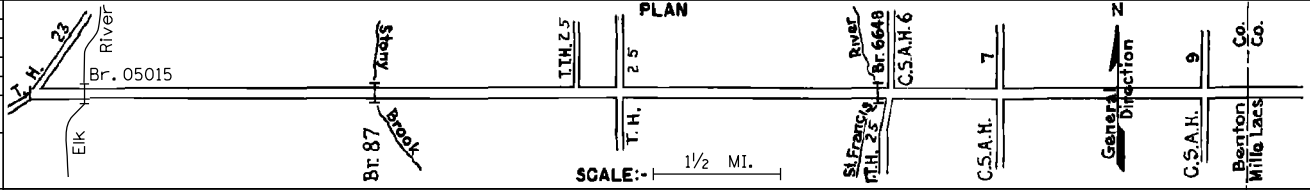

YEAR BUILT	PROJECT No	DESCRIPTION			REMARKS
		TYPE	WIDTH	THICKNESS	
C	1986 M4191	Bit. Overlay	28'	2"	Spec 2341
			24'	1 1/2"	
M	1989 0505-19	Aggregate Seal			
C	1990 M4379	Bit. Overlay	24'	1 1/2"	Spec 2341
C	1992 M4551	Bit. Overlay	24'	1 1/2"	Spec 2341
C	1995 0505-22	Bit. Overlay	28'	3 1/2"	Spec 2341
C	1995 0505-17	Grading Bit. Surfacing Remove/Construct Bridge	48' 24'	4 1/2"	Spec. 2341, 2331 * See Remarks
S	2001 0505-23	Grading Aggregate Base Mill & Bit. Surfacing	10' 6'	3"	Class 1 & 6 Spec. 2350
S	2007 0505-24	Milling Bit. Overlay	24'	1 1/2"	Spec. 2360
	2013 8823-262	Bit. Seal Coat	24'		Type FA2

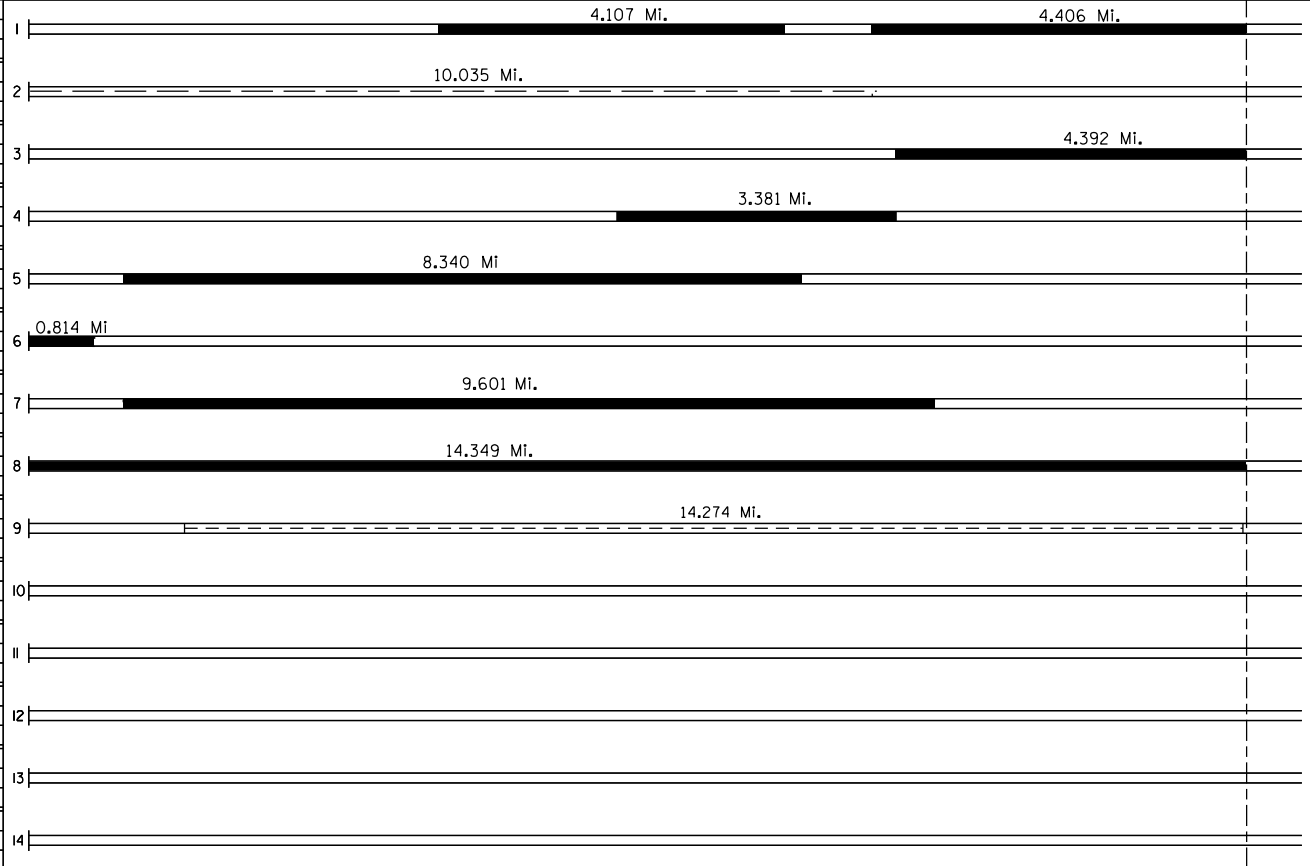

YEARS		TOTAL MILES	UNINCORPORATED		INCORPORATED		RURAL		URBAN	
FROM	TO		RDWY. MI.	BR. MI.	RDWY. MI.	BR. MI.	RDWY. MI.	BR. MI.	RDWY. MI.	BR. MI.

REMARKS: * Remove Bridge No's 1766 and L5807, Construct Bridge No's 05015 and 97591