

PREPARED BY  
HIGHWAY PLANNING SURVEY  
IN COOPERATION WITH  
U. S. PUBLIC ROADS ADMINISTRATION

STATE OF MINNESOTA  
DEPARTMENT OF HIGHWAYS  
ROAD LIFE STUDIES  
CONSTRUCTION PROJECT LOG RECORD

CONTROL SECTION 1121  
TRUNK HIGHWAY 290  
COUNTY CASS  
DISTRICT 3A2A

LIMITS: Jct. T.H. 371 - Minnesota State Sanatorium  
Ref. Pt. 000+00.000 - 000+00.400

Minnesota State Sanatorium (Ah-Gwah-Ching) PLAN  
Adm. Bldg.

YEAR BUILT	PROJECT N°	DESCRIPTION			CODE N° Dist.
		TYPE	WIDTH	THICK- NESS	
		Mixed Bit.	18' 7"		
					No Record of Const. Added in 1951
C 1953	A.F.E. 604	Bit. Resurfacing Mixed Bit.	18' 7"	1"	MC-2, 4598 Gal. Agg. 353 Tons
C 1993	1121-01	Bit. Overlay	24'	1 1/2"	Spec. 2341
2011	1121	Control Section Retire L.R. 290 TH 290			Effective April 1, 2011

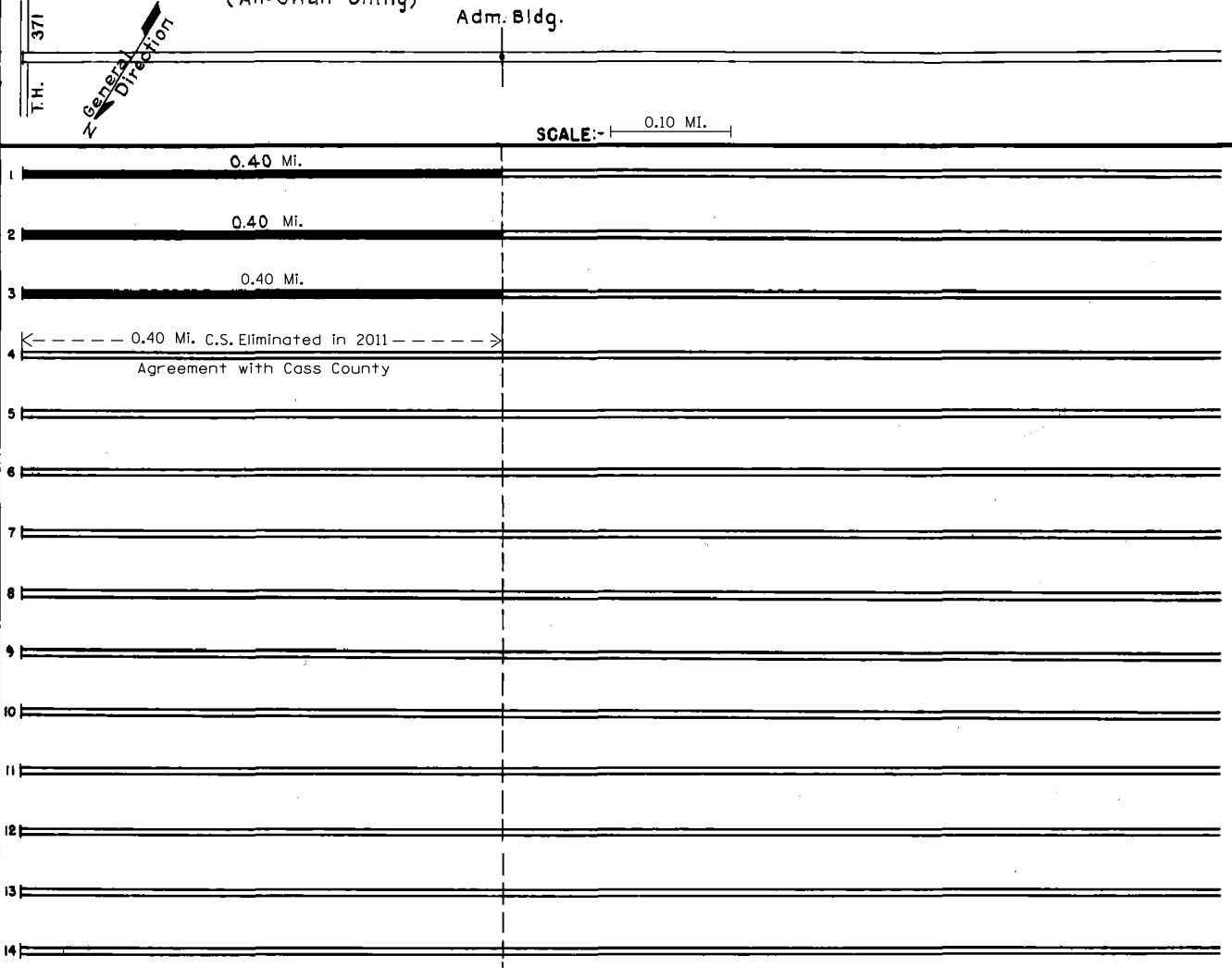

YEARS		TOTAL MILES	UNINCORPORATED		INCORPORATED		RURAL		URBAN		
FROM	TO		RDWY. MI.	BR. MI.	RDWY. MI.	BR. MI.	RDWY. MI.	BR. MI.	RDWY. MI.	BR. MI.	
1951		0.40	0.40	0.00	0.00	0.00	0.00	0.40	0.00	0.00	0.00

REMARKS: Layout is to scale as of 1951