

PREPARED BY  
HIGHWAY PLANNING SURVEY  
IN COOPERATION WITH  
U. S. PUBLIC ROADS ADMINISTRATION

STATE OF MINNESOTA  
DEPARTMENT OF HIGHWAYS  
ROAD LIFE STUDIES  
CONSTRUCTION PROJECT LOG RECORD

CONTROL SECTION 2110  
TRUNK HIGHWAY 114  
COUNTY Douglas  
DISTRICT 4B

LIMITS: South Co. Line - Jct. T.H. 27

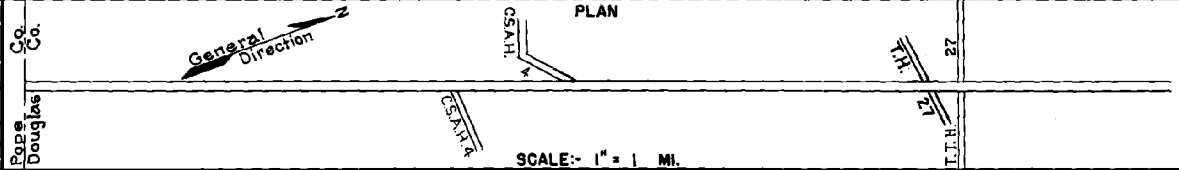

YEAR BUILT	PROJECT N°	DESCRIPTION			CODE N°
		TYPE	WIDTH	THICKNESS	
		Gravel	20'	2"	No Record of Constr.
		Grading			Added in 1934.
1932		Gravel	20'	2"	Co. Job 3103 1000 C.Y./Mile Added in 1934
		Grading			Co. Job 3218
1933		Gravel	20'	2"	1000 C.Y./Mile Added in 1934
M	1940 A.F.E. 20	Regraveling			230 C.Y./Mi. Maint. Dept.
M	1944 A.F.E. 6	Grade Lifts & Grav. Resurfacing (Spots)			297 C.Y./Mi. Maint. Div.
M	1945 A.F.E. 6	Grav. Resurfacing			335 C.Y./Mi. Maint. Div.
M	1946 A.F.E. 6	Grav. Resurfacing	24'		465 C.Y.
M	1947 A.F.E. 6	Grav. Resurfacing	24'		2180 C.Y.
M	1970 A.F.E. 6	Gravel Resurfacing	24'		1364 C.Y.
M	1951 A.F.E. 6	Grav. Resurfacing			2269 C.Y.
M	1953 A.F.E. 606	Grav. Resurfacing (Spots)	24'		325 C.Y.
C	1955 2110-02	Grading Gravel	38' 28'	1 1/2"	700 C.Y./Mi
C	1956 2110-03	Sand-Grav. Sub-base Gravel Base Plant Mix Bit.	32' 32' 24'	6" 3" 1 1/2"	
M	1957 A.F.E. 605	Bit. Seal Coat	24'		RS-2, 25008 Gal. Agg. 936 C.Y.

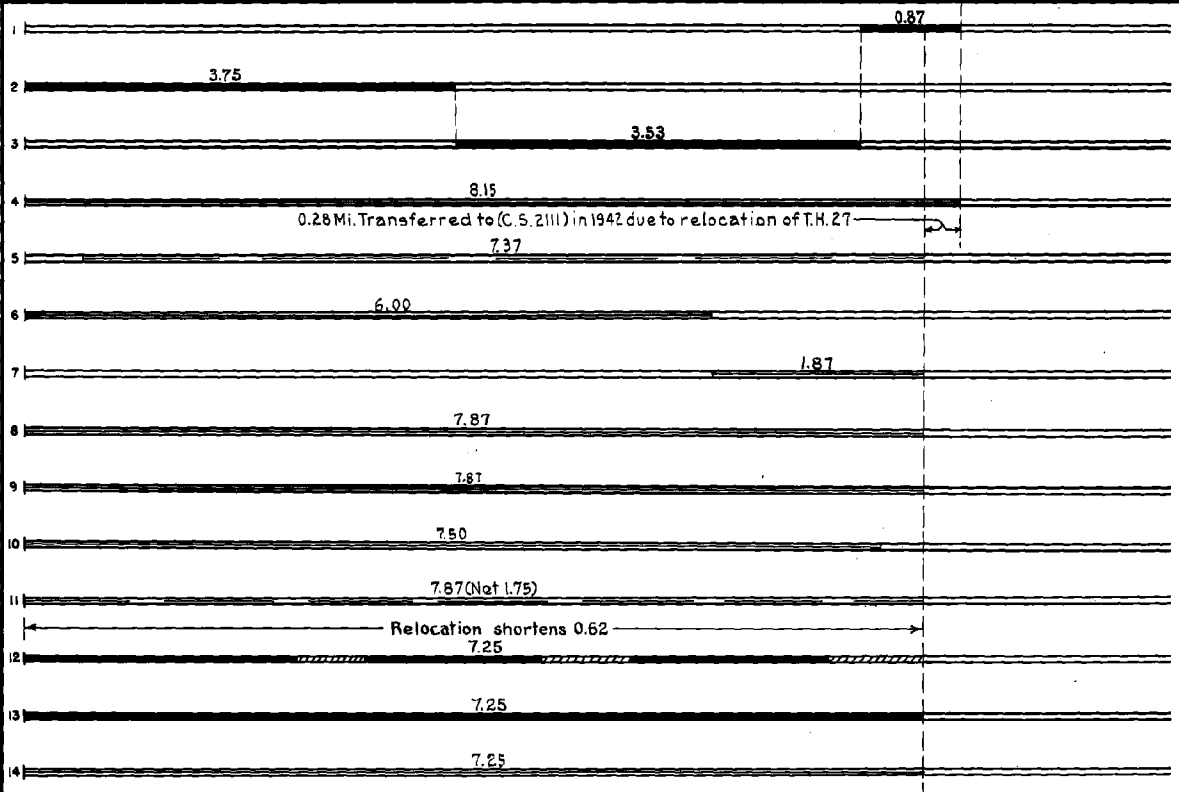

YEARS		TOTAL MILES	UNINCORPORATED		INCORPORATED		RURAL		URBAN	
FROM	TO		ROWY. MI.	BR. MI.	ROWY. MI.	BR. MI.	ROWY. MI.	BR. MI.	ROWY. MI.	BR. MI.
1934	1941	8.15	8.15	0.00	0.00	0.00	8.15	0.00	0.00	0.00
1942	1954	7.87	7.87	0.00	0.00	0.00	7.87	0.00	0.00	0.00
1955		7.25	7.25	0.00	0.00	0.00	7.25	0.00	0.00	0.00

REMARKS: Layout is to scale as of 1934

