

PREPARED BY
TRAFFIC AND PLANNING DIVISION
IN COOPERATION WITH
U.S. DEPARTMENT OF COMMERCE
BUREAU OF PUBLIC ROADS

STATE OF MINNESOTA
DEPARTMENT OF HIGHWAYS
ROAD LIFE STUDIES
CONSTRUCTION PROJECT LOG RECORD

CONTROL SECTION 2180B
Interstate TRUNK HIGHWAY 94
COUNTY Douglas
DISTRICT 4B

LIMITS: Jct. T.H. 114 - E. Co. Line

YEAR BUILT	PROJECT NO	DESCRIPTION	WIDTH	THICKNESS	REMARKS
C	2180-0709&10	Grading			Divided Highway
1967	2180-21807&106	Br's 21805 & 21806	38' & 38'		Both 125' B.S.-O.H.
	2180-21807	Br. 21807			275' B.S.-U.P.
C	2180-27&28	Sub-base & Base P.C. Concrete	2 @ 24"	9"	
C	2180-21813&14	Br's 21813 & 21814			Both 235' B.S.-U.P.
1967	2180-21815&16	Br's 21815 & 21816	38' & 38'		Both 140' B.S.-O.H.
	2180-21817&18	Br's 21817 & 21818	38' & 38'		Both 111' B.S.-O.H.
C	2180-21819	Br. 21819			212' B.S.-U.P.
1967	2180-21820	Br. 21820			212' B.S.-U.P.
	2180-21821	Br. 21821			285' B.S.-U.P.
M	1976	2180-SF			13800 TONS H SPEC #135- 48 PAISLS #157-87; #136- 135; #155-11
M	1977	2180-SF			JOINT SEAL
M	1980	2180-21821	35.75'		Bridge Repair
C	1981	2180-62			Gene. Pavt. Repair
C	1981	2180-21815			Br. Deck Repair & Overlay
	2180-21816	Br. 21815, 21816			
	2180-21817, 21818				
C	1982	2180-21805			Br's 21805, 21806 21807, 21810
C	1983	2180-21813	30' 2"	2"	Br's 21813, 21814 Br. Deck Widening 38'-5" 2"
M	1984	2180-60			130.8 Mi. For 1402-11, 1480-86, 2180-60, 2680-28 5680-91, 6480-21
M	1984	SF	9' 1-1/2"		Sp. 2341 22 Tons E.B. under T.H. 127

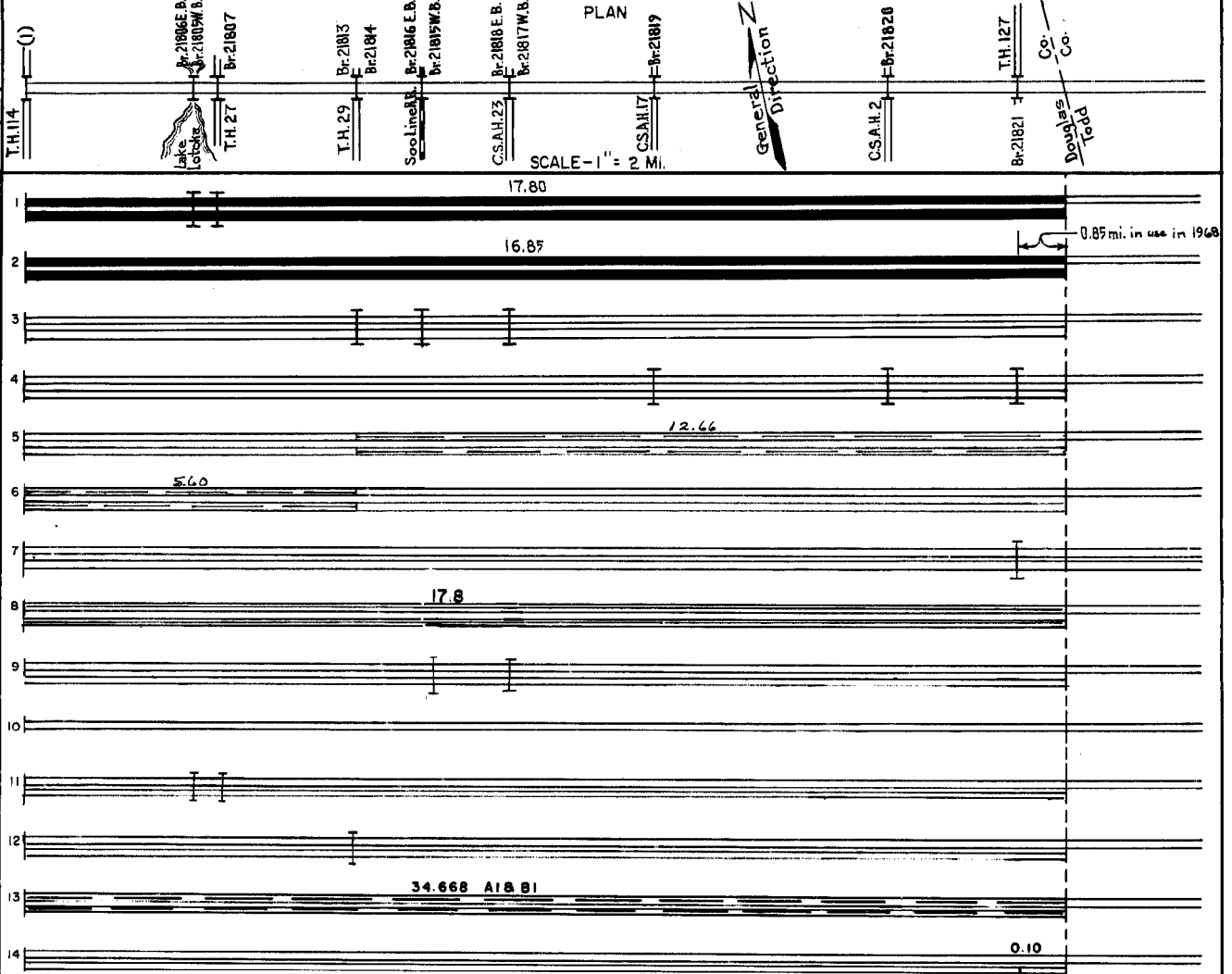

YEARS		TOTAL MILES	UNINCORPORATED		INCORPORATED		RURAL		URBAN	
FROM	TO		RDWY. MI.	BR. MI.	RDWY. MI.	BR. MI.	RDWY. MI.	BR. MI.	RDWY. MI.	BR. MI.
1967		16.95	16.88	0.07	0.00	0.00	16.88	0.07	0.00	0.00

REMARKS: Layout is to scale as of 1967.
(1) See sheet A1 for bridges at T.H. 114.

PREPARED BY
BUREAU OF POLICY & PLANNING
IN COOPERATION WITH
U. S. DEPARTMENT OF TRANSPORTATION - FEDERAL HIGHWAY ADMINISTRATION

STATE OF MINNESOTA
DEPARTMENT OF TRANSPORTATION
CONSTRUCTION PROJECT LOG RECORD

CONTROL SECTION 2180B
TRUNK HIGHWAY I-94
COUNTY Douglas
DISTRICT 4B

LIMITS: Jct. T.H. 114 - E. Co. Line
Ref. Pt. 097+00.479 - 115+00.283

YEAR BUILT	PROJECT No	DESCRIPTION				REMARKS
		TYPE	WIDTH	THICKNESS		
C	1998 2180-80	Bonded & Unbonded Concrete Overlay	27'	8"	non Reinforced	
M	1999 M99221	Crack Repair				
C	2000 2180-87	Milling Bit. Overlay	24'	4 1/2"	Spec. 2360	
M	2000 8824-20	Crack Sealing			Type 3720	
C	2004 2180-92	Bit. Milling Bit. Overlay	24'	3"	Spec. 2360	
C	2008 2180-96	Bit. Milling Bit. Overlay	25'	2"	W.B. only	
C	2011 8824-97	Ultra Thin Overlay	26'	.625"	Spec. 2356 W.B. only	
C	2017 2180-108	Grading Bit. Mill & Ovl 1-94 ramps Bit. Surf. approachs	var.	4"	Rehab. Br.21821 Recon. M/O TH 27 3'- 5' Agg. base 9" cl.5	
M	2018 8824-156	rumble strips shldr rumble strips		12"	12" RT	
C	2018 2180-109	Grading Bit. Surfacing Conc. Surfacing	var.	4"-6"	Br. Rehab. var. milling 5.5"	
C	2019 2180-104	Grading Bit. Surfacing shldr Conc. Surfacing	var.	4.5"	Br. 21829, Br. 21830 13" agg. base cl.5 8" agg. base cl.5	
C	2019 2180-115	Grading Concrete Pvm't Bit. mix PASSRC	29'	8"	agg. base cl.5 9" Bit. shldr 4" Bit. layer 1 1/4"-5 1/8"	

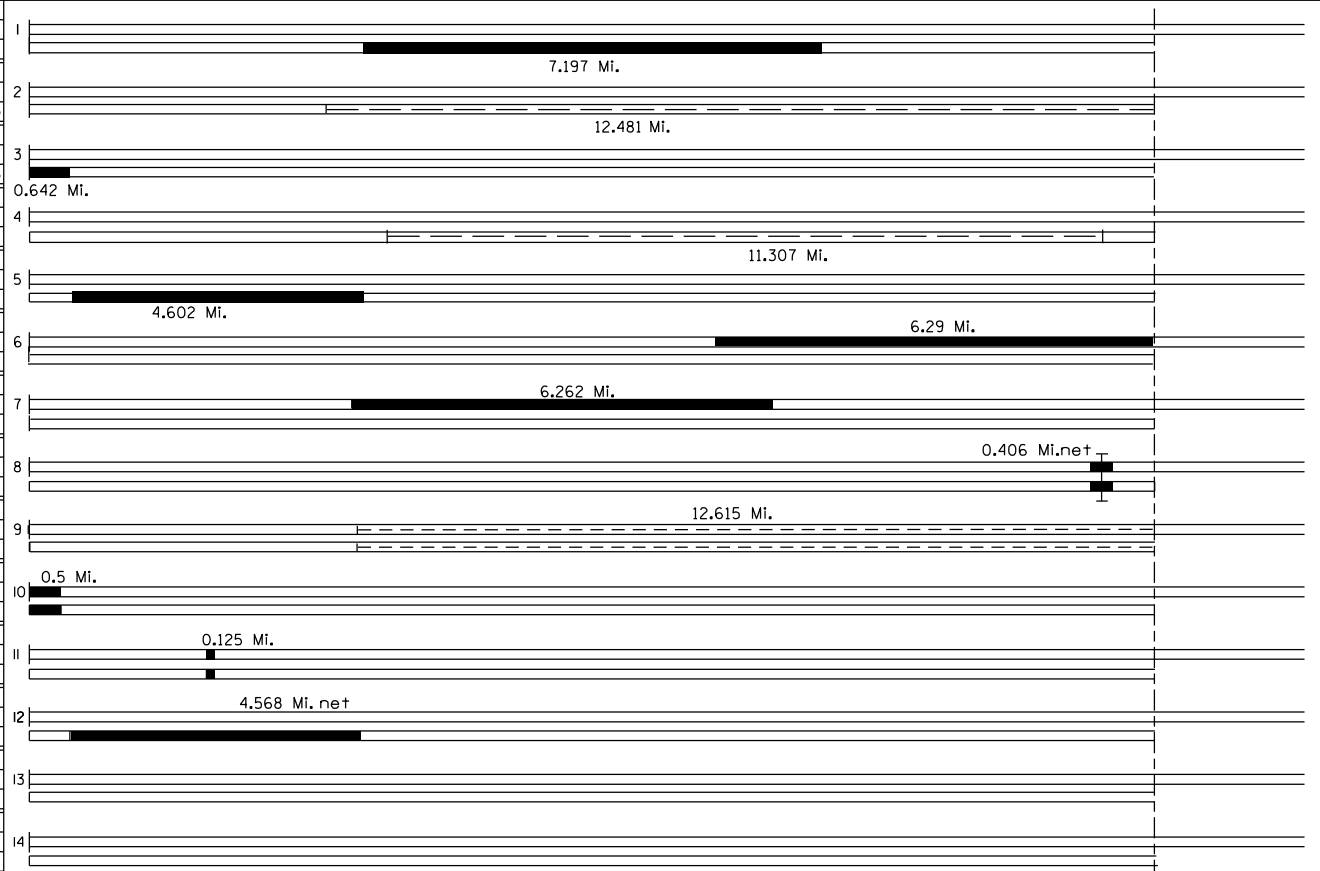
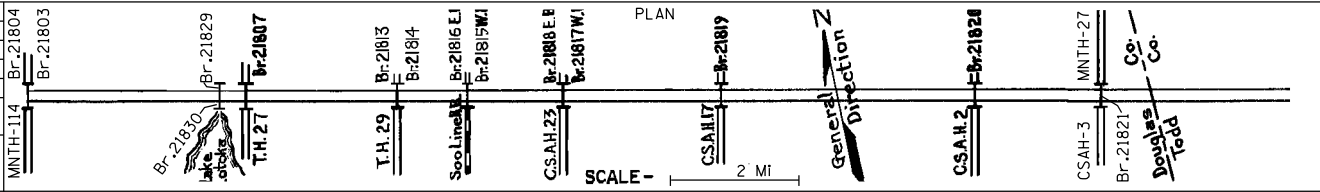

YEARS FROM TO		TOTAL MILES	UNINCORPORATED RDWY. MI. BR. MI.		INCORPORATED RDWY. MI. BR. MI.		RURAL RDWY. MI. BR. MI.		URBAN RDWY. MI. BR. MI.	

REMARKS: