

PREPARED BY
HIGHWAY PLANNING SURVEY
IN COOPERATION WITH
U.S. PUBLIC ROADS ADMINISTRATION

STATE OF MINNESOTA
DEPARTMENT OF HIGHWAYS
ROAD LIFE STUDIES
CONSTRUCTION PROJECT LOG RECORD

CONTROL SECTION 410
TRUNK HIGHWAY 14
COUNTY Lincoln
DISTRICT 8B

LIMITS: Y. State Line-N.Jct.T.H.75 in Lake Benton

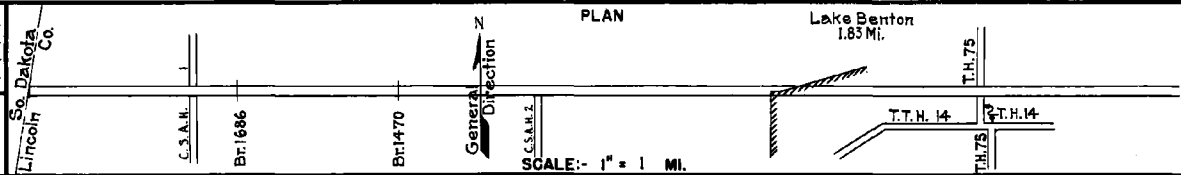

YEAR BUILT	PROJECT N ^o	DESCRIPTION			CODE N ^o
		TYPE	WIDTH	THICKNESS	
	14-7-01	Gravel R/W Purchase	20'	2"	No Record of Const.
1932	14-7-41-2A	Gravel Br. 1686 & 1470	26'	1 1/2"	800 C.Y./Mile. 2-N1081.
1934	14-7-41-2A	Gravel	26'	6"	2460 C.Y./Mile.
1935	14-7-41-2A	Oil Tr. Gravel	24'	1"	16000 Gal./Mile. Maint. Dept.
M	1940 A.F.E. 22	Bit. Retreat.			RG2-MC3-4019 Gal./Mi. Grav. 165 C.Y./Mi. Maint. Dept.
C	1942 4101-01	Roadside Develop.			
M	1944 A.F.E. 5	Bit. Seal Coat			RG3, 3009 Gal./Mi. Agg. 67 C.Y./Mi. Maint. Div.
M	1945 A.F.E. 4	Spot Treat. Bit. Surf. Repair & Frost Bolt Lift			Bit. 4768 Gal./Mi. Grav. 287 C.Y./Mi. Maint. Div.
M	1946 A.F.E. 4	Spot Treat. Bit. Surf. Repair	24'		MC3, 850-3, 4262 Gal. Agg. 210 C.Y.
M	1947 A.F.E. 4	Spot Treat. Bit. Surf. Repair	27'		MC3, 8485 Gal. Agg. 539 Tons
C	1948 A.F.E. 17	Grav. Lift (Spots) Bit. Resurfacing Mixed Bit.	24'	1"-18" added	MC3, 103907 Gal. Agg. 5771 Tons
M	1950 A.F.E. 4	Spot Treat. Bit. Surf. Repair	24'		MC28562, 9578 Gal. Agg. 634 Tons
M	1951 A.F.E. 4	Spot Treat. Bit. Surf. Repair	24'		SC3, 4411 Gal. Agg. 249 C.Y.
M	1952 A.F.E. 4	Spot Treat. Bit. Surf. Repair	24'		MC28563, 12137 Gal. Agg. 648 C.Y.

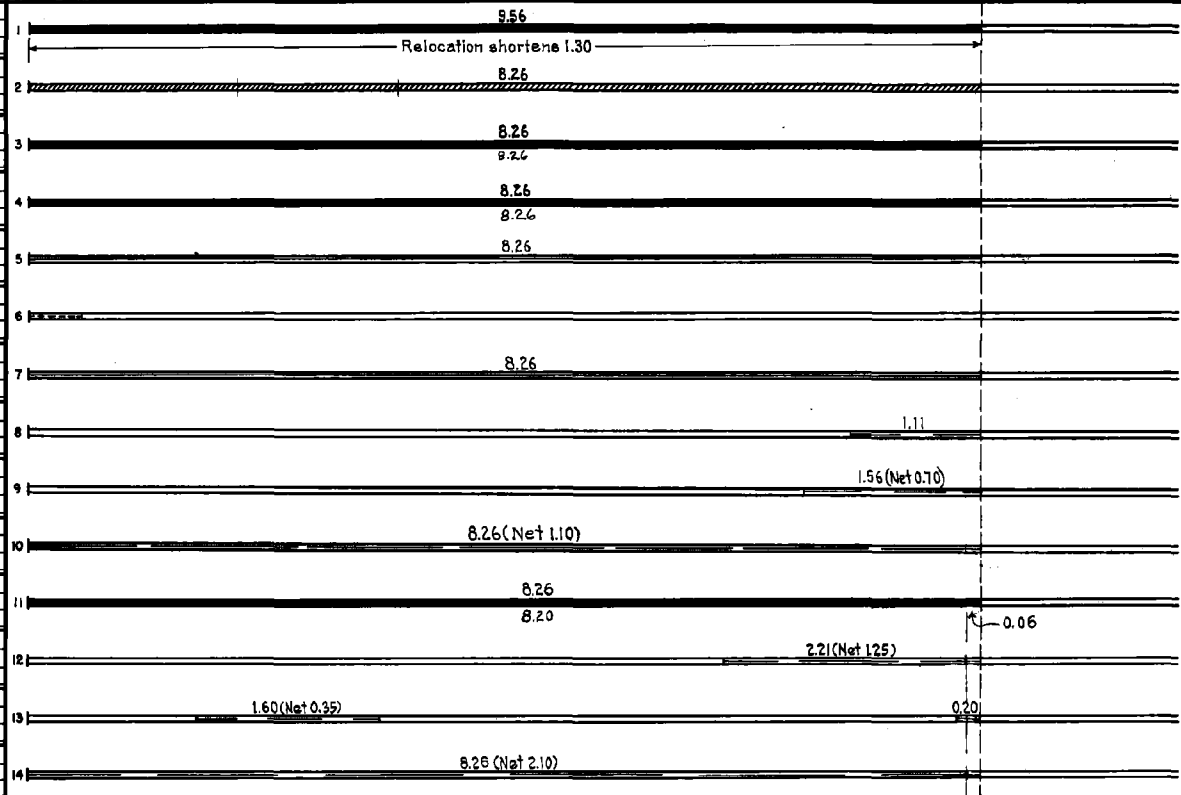

YEARS FROM	TO	TOTAL MILES	UNINCORPORATED		INCORPORATED		RURAL		URBAN	
			RDWY. MI.	BR. MI.	RDWY. MI.	BR. MI.	RDWY. MI.	BR. MI.	RDWY. MI.	BR. MI.
1921	1931	9.56	7.56	0.00	2.00	0.00	9.56	0.00	0.00	0.00
1932		8.26	6.43	0.00	1.83	0.00	8.26	0.00	0.00	0.00

REMARKS: Layout is to scale as of 1932

(1) Accumulated thickness
(2) This work not done under this project number but lies within the limits of this project

3-75

PREPARED BY
HIGHWAY PLANNING SURVEY
IN COOPERATION WITH
U. S. PUBLIC ROADS ADMINISTRATION

STATE OF MINNESOTA
DEPARTMENT OF HIGHWAYS
ROAD LIFE STUDIES
CONSTRUCTION PROJECT LOG RECORD

CONTROL SECTION 4101
TRUNK HIGHWAY 14
COUNTY Lincoln
DISTRICT 8B

LIMITS: N. State Line - N. Jct. T.H. 75 in Lake Benton

Ref. Pr. 000-00.000 - 000-00.250

YEAR BUILT	PROJECT N ^o	DESCRIPTION				CODE N ^o
		TYPE	WIDTH	THICKNESS	REMARKS	
M 1954	A.F.E. 604	Spot Treat. Bit. Surf. Repair	24'		MC2 & SC-3, 10160 Gal. Agg. 711 Tons	
M 1955	A.F.E. 604 A.F.E. 605	Spot Treat Bit. Surf. Repair Spot Seepage Pipe Seal	24'		SC3 & MC2, 19363 Gal. Agg. 974 Tons & 194 CY.	
M 1956	A.F.E. 604	Spot Treat Bit. Surf. Repair	24'		SC-3, 14763 Gal. Agg. 1008 Tons	
M 1957	A.F.E. 604	Spot Treat Bit. Surf. Repair	24'		SC-3 & MC-2, 5893 Gal. Agg. 386 Tons	
M 1958	A.F.E. 604	Spot Treat Bit. Surf. Repair	24'		SC-3, 9921 Gal. Agg. 677 Tons	
M 1959	A.F.E. 604	Spot Treat Bit. Surf. Repair	24'	3/4"	SC-3 & MC-2, 2865 Gal. Agg. 169 Tons	
M 1960		Spot Treat Bit. Surf. Repair	24'		SC-3 & MC-2, 11940 Gal. Agg. 730 Tons	
M 1961		Spot Treat Bit. Surf. Repair	24'		SC-3, 3146 Gal. for Repair & 423 Gal. for Tack	
C 1964	4102-07	Grading Sub-base Base			Intersection Development	
C 1975	4101-04	Plant mix Bit. Gravel Shoulders	Var. 3 1/2" 24' 1 1/2"			
C 1985	4101-08	Bit. Surfacing Agg. Shoulders	28' 5 1/2" 5' Var.			
M 1986	M4314	Bit. Sealing				
M 1993	M93149	Seal Coat Surface				
M 1999	M99190	Bit. Overlay	24'	1 1/2"	Spec. 2341	

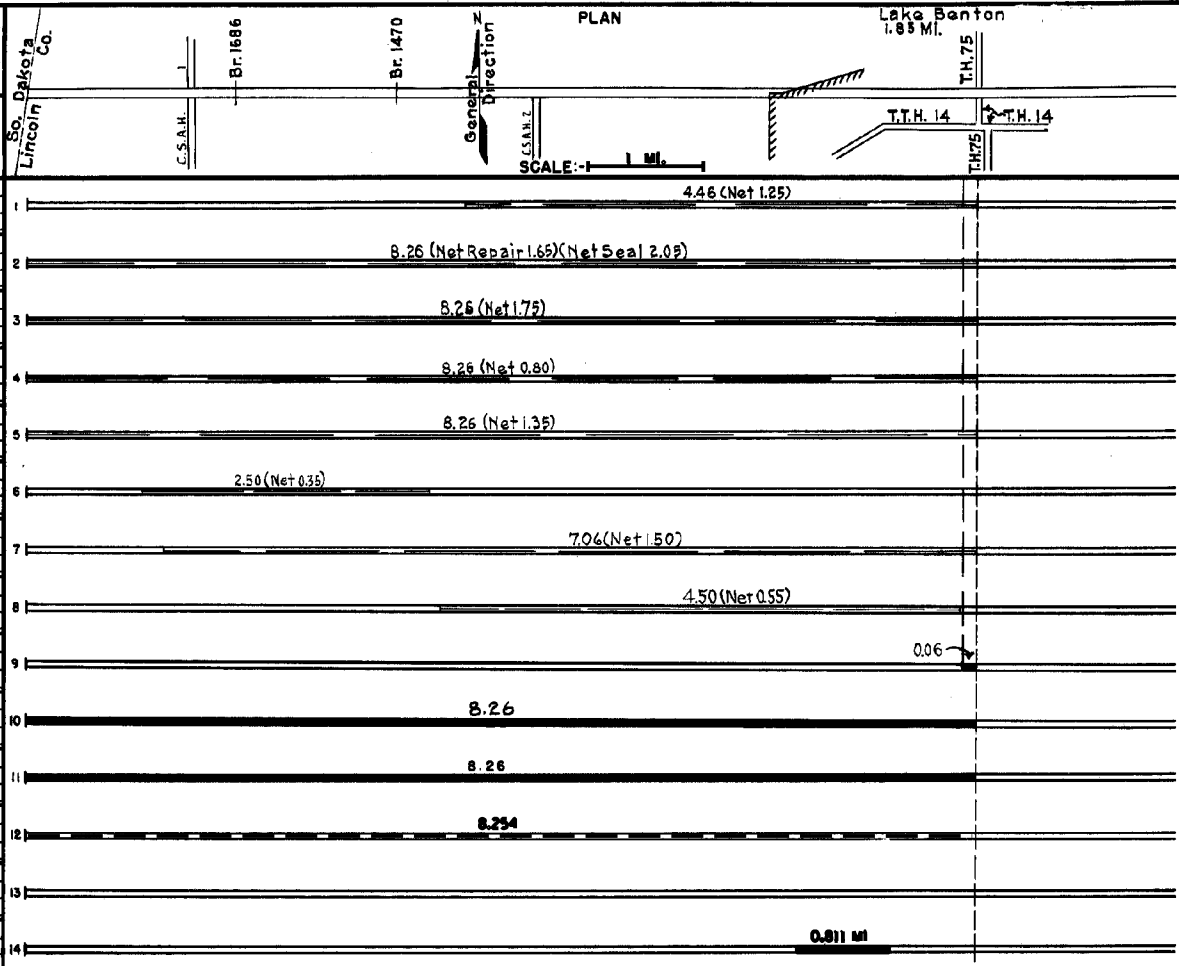

YEARS FROM	TO	TOTAL MILES	UNINCORPORATED		INCORPORATED		RURAL		URBAN	
			RDWY. MI.	BR. MI.	RDWY. MI.	BR. MI.	RDWY. MI.	BR. MI.	RDWY. MI.	BR. MI.

REMARKS: See Sheet No. 1

