

PREPARED BY
HIGHWAY PLANNING SURVEY
IN COOPERATION WITH
U. S. PUBLIC ROADS ADMINISTRATION

STATE OF MINNESOTA
DEPARTMENT OF HIGHWAYS
ROAD LIFE STUDIES
CONSTRUCTION PROJECT LOG RECORD

CONTROL SECTION 5506
TRUNK HIGHWAY 42
COUNTY Olmsted
DISTRICT 6A

LIMITS: Jct T.H. 14 - No. Co. Line

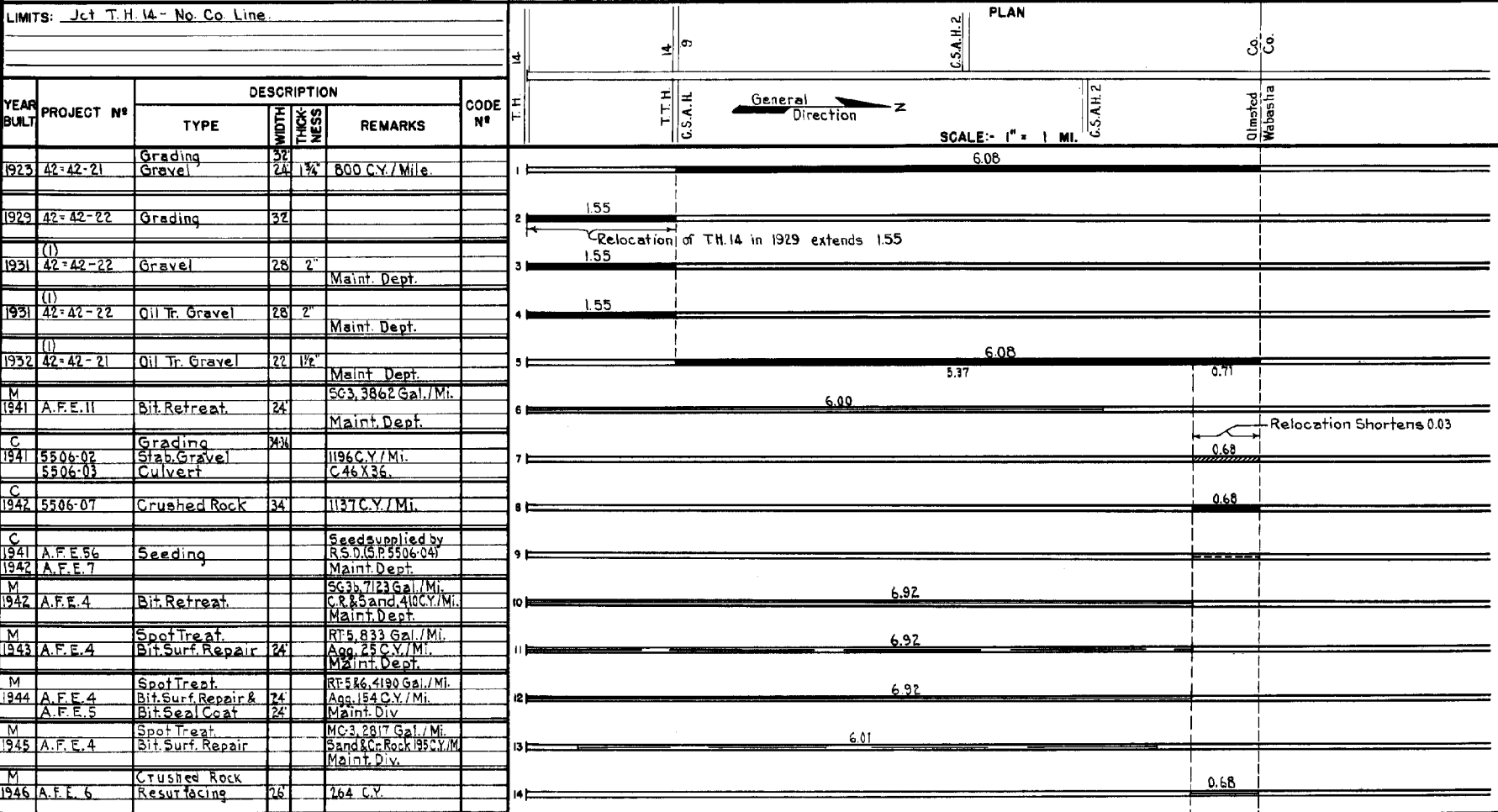

YEARS FROM	TO	TOTAL MILES	UNINCORPORATED		INCORPORATED		RURAL		URBAN	
			RDWY. MI.	BR. MI.	RDWY. MI.	BR. MI.	RDWY. MI.	BR. MI.	RDWY. MI.	BR. MI.
1923	1928	6.08	6.08	0.00	0.00	0.00	6.08	0.00	0.00	0.00
1929	1940	7.63	7.63	0.00	0.00	0.00	7.63	0.00	0.00	0.00
1941	1949	7.60	7.60	0.00	0.00	0.00	7.60	0.00	0.00	0.00
1950		7.55	7.55	0.00	0.00	0.00	7.55	0.00	0.00	0.00

REMARKS: Layout is to scale as of 1930

① This work not done under these project numbers but lies within the limits of these projects.

PREPARED BY
HIGHWAY PLANNING SURVEY
IN COOPERATION WITH
U. S. PUBLIC ROADS ADMINISTRATION

STATE OF MINNESOTA
DEPARTMENT OF HIGHWAYS
ROAD LIFE STUDIES
CONSTRUCTION PROJECT LOG RECORD

CONTROL SECTION 5506
TRUNK HIGHWAY 42
COUNTY Olmsted
DISTRICT 6A

LIMITS: Jct. T.H. 14 - N. Co. Line

YEAR BUILT	PROJECT N ^o	DESCRIPTION			CODE N ^o
		TYPE	WIDTH	THICKNESS	
C	1947 5506-10	Crushed Rock Base Plant Mix. Bit.	32'	3'-9" 1 1/2"	
M	1947 A.F.E. 4	Spot Treat. Bit. Surf. Repairs			MC-3 385 C.G., 19056 Gal. Agg. 1026 C.Y.
M	1948 A.F.E. 4	Spot Treat. Bit. Surf. Repair	24'		SC-3, 24410 Gal. Agg. 1375 C.Y.
M	1949 A.F.E. 4	Spot Treat. Bit. Surf. Repair	24'		SC-4, 25066 Gal. Agg. 1664 C.Y.
M	1950 A.F.E. 4	Light Bit. Seal	24'		AE-1, 790 Gal. Agg. 23 C.Y.
C	1950 5506-08	Grading Crushed Rock Culverts (2)	38' 24'	1.0' Select Mat'l. 2 1/2"	1200 C.Y./Mi.
M	1950 A.F.E. 6	Cr. Rock Resurfacing (Spots)			304 C.Y.
C	1952 5506-11	Cr. Rock Base Plant Mix Bit.	32' 24'	9'-12" 1 1/2"	
M	1954 A.F.E. 605	Light Bit. Seal	24'		RCS-1, 913 Gal. Agg. 36 C.Y.
M	1957 A.F.E. 824 A.F.E. 605	Spot Subgr. Corr. Restore Bit. Surf. Light Bit Seal (755 Mi.)	24'		MC2&RC-1, 21780 Gal. Bit. Mix 221 Tons Seal Agg. 645 C.Y.
M	1959 A.F.E. 604	Bit. Surf. Repair	24'		MC-2, 3844 Gal. Bit. Mix 222 Tons
M	1960	Spot Treat. Bit. Surf. Repair	Var		MC-2, 4267 Gal. Agg. 338 Tons
M	1961	Spot Bit. Surf. Repair Light Bit. Seal	24' 25'	3/4"	MC-2, 892 Gal. RC-2, 2008 Gal. Seal Agg. 59 C.Y.
M	1962	Light Bit. Seal Spot Treat Bit. Surf. Repair	24'		MC-2 & RC-2, 3758 Gal. Bit. Mix 182 Tons

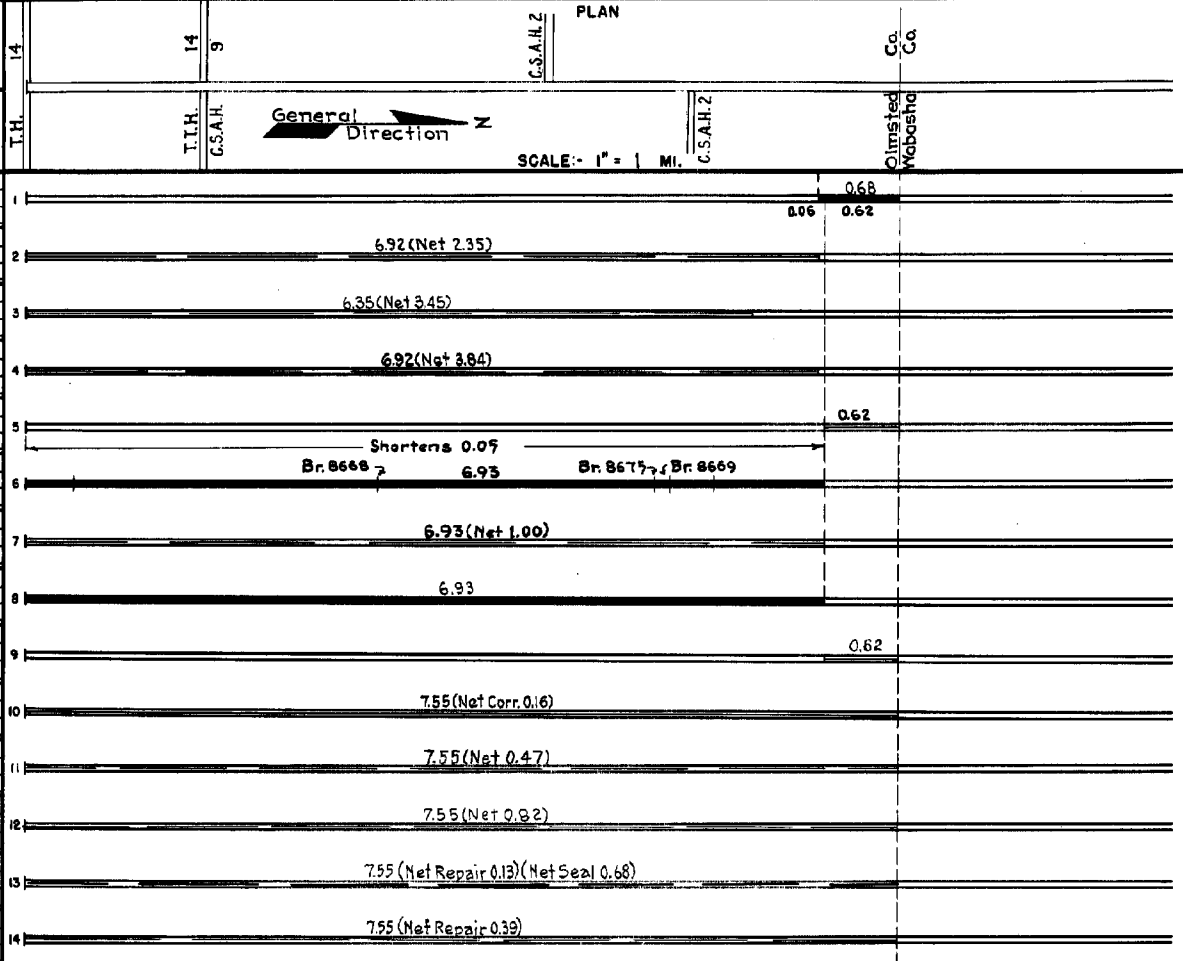

YEARS FROM	TOTAL MILES	UNINCORPORATED		INCORPORATED		RURAL		URBAN	
		RDWY. MI.	BR. MI.	RDWY. MI.	BR. MI.	RDWY. MI.	BR. MI.	RDWY. MI.	BR. MI.

REMARKS: See Sheet N^o 1 (1) Contract not final but work substantially complete in 1947.
(2) C&G N (Br. 8668), extend W 46, W 108 (Br. 8677), W 108 (Br. 8669), & W 88.

PREPARED BY
TRAFFIC AND PLANNING DIVISION
IN COOPERATION WITH
U.S. DEPARTMENT OF COMMERCE
BUREAU OF PUBLIC ROADS

STATE OF MINNESOTA
DEPARTMENT OF HIGHWAYS
ROAD LIFE STUDIES
CONSTRUCTION PROJECT LOG RECORD

CONTROL SECTION 5506
TRUNK HIGHWAY 42
COUNTY Olmsted
DISTRICT 6A

LIMITS: Jct. Isth 90 - Olmsted/Wabasha Co. line

Ref. Pt. 000+00.000 - 007+00.566

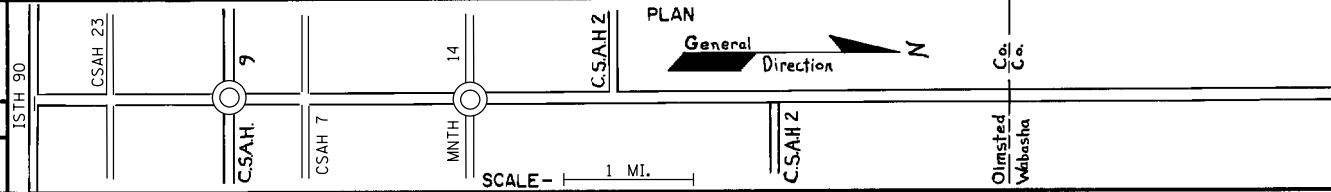

YEAR BUILT	PROJECT NO.	DESCRIPTION			
		TYPE	WIDTH	THICKNESS	REMARKS
M 1963		Light Bit Seal Spot Treat Bit Surf Repair	25'		RC-2, 1919 Gal. Agg. 660 C.Y. Bit. Mix 257 tons
M 1965	SF	Spot Treat Bit Surf. Repair	24'	3/4"	Jack 648 Gal. Bit. Mix 527 Tons
C 1966	5506-14	Grading & Base P.C. Concrete	24'	7"	On portions of Proj.
C 1990	SF	Bit. Overlay	24'	3"	Spec. 2341
C 1993	SF	Bit. Overlay	24'	1 1/2"	Spec. 2341
C 1995	5506-15	Auxiliary Lanes			
C 1996	5506-17	Bit. Overlay	24'	4"	Spec. 2347
M 1998	5506-19	Major Crack Repair			
C 1999	55-607-11	Unbonded Concrete Overlay	24'	1" 8"	PASSRC 15' spans
C 2015	5506-26	Grading/Agg. Base Bit. Surfacing Conc. Surfacing	var.	6" 7" 8.5"	Class 5 Spec. 2360 (Roundabout)
C 2015	5506-22	Grading Bit. Milling Bit. Overlay	var.	1.5" var.	Spec. 2360
C 2015	8826-150	Conc. Pavement Rehab.	24'		
C 2018	5506-27	Grading Roundabout Conc. Surf. gore ADA & bit. shldr	var.	7.5" 7"	4' agg. base, cl. 50 7' agg. base, cl. 50

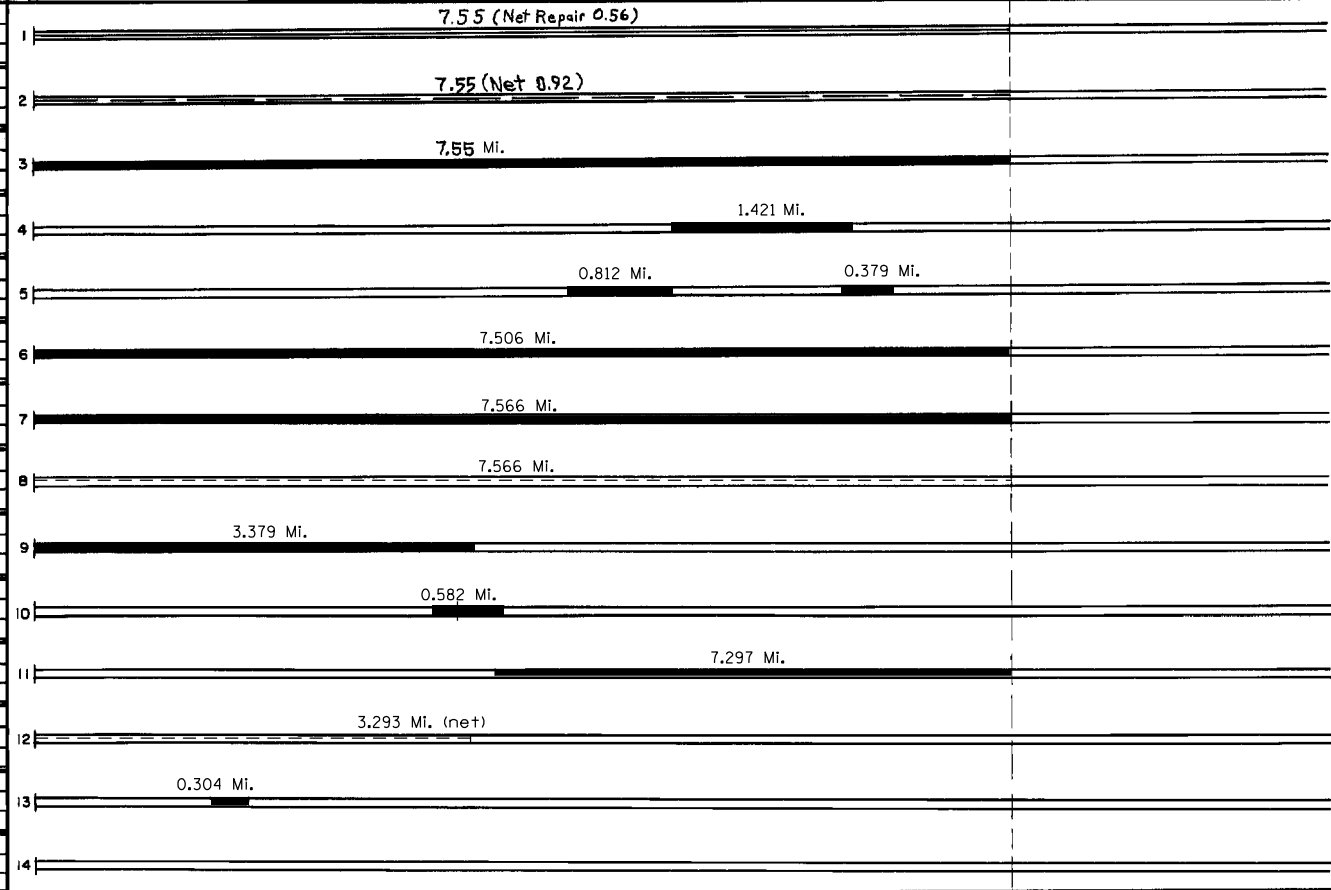

YEARS		TOTAL MILES	UNINCORPORATED		INCORPORATED		RURAL		URBAN	
FROM	TO		RDWY. MI.	BR. MI.	RDWY. MI.	BR. MI.	RDWY. MI.	BR. MI.	RDWY. MI.	BR. MI.

REMARKS: See Sheet No. 1