

PREPARED BY
HIGHWAY PLANNING SURVEY
IN COOPERATION WITH
U.S. PUBLIC ROADS ADMINISTRATION

STATE OF MINNESOTA
DEPARTMENT OF HIGHWAYS
ROAD LIFE STUDIES
CONSTRUCTION PROJECT LOG RECORD

CONTROL SECTION 5808
TRUNK HIGHWAY 18
COUNTY Pine
DISTRICT 1A

LIMITS: W. Co. Line - Jct. T.H. 23

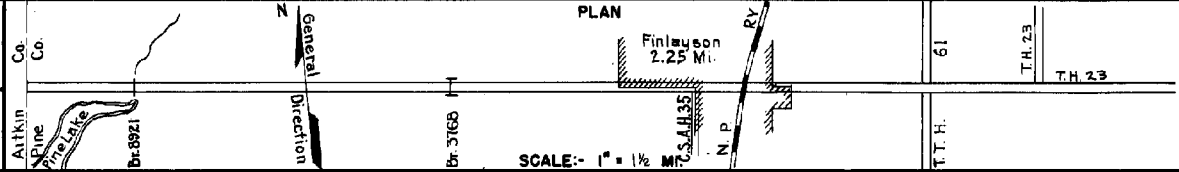

YEAR BUILT	PROJECT N°	DESCRIPTION		REMARKS	CODE N°
		TYPE	WIDTH THICKNESS		
		Gravel	22' 2"	No Record of Constr. Added in 1934.	
		Br. X-385 & 3768 (1)	17'	14 D.S. & 23 C.D.G.	
1935	66-186-22	Grading	28'		
	(1)				
1935	66-186-22	Gravel	28' 2"	Maint. Dept.	
1937		Br. 519	27'	14 D.S. Maint. Dept.	
	C	Gravel Lift	24' 3"		
1940	A.F.E. 60	Bit. Surf. Treat.	24' 3/4"	Maint. Dept.	
	M				
1941	A.F.E. 55	Frost Boil Corr.		Grav. 329 C.Y./Mi. Maint. Dept.	
	M				
1941	A.F.E. 29	Spot Graveling Reshape & Ditch	24' 30"	206 C.Y./Mi. Maint. Dept.	
	M				
1941	A.F.E. 14	Bit. Retreat	24'	503,867.2 Gal./Mi. Maint. Dept.	
	M				
1943	A.F.E. 4	Spot Treat. Bit. Surf. Repair		MG 2,450.2 Gal./Mi. Agg. 200 C.Y./Mi. Maint. Dept.	
	M				
1944	A.F.E. 4	Spot Treat. Bit. Surf. Repair		MG 2,312.9 Gal./Mi. Maint. Div.	
	M				
1945	A.F.E. 4	Spot Treat. Bit. Surf. Repair		MG 2,439.7 Gal./Mi. Agg. 241 C.Y./Mi. Maint. Div.	
	M				
1945	A.F.E. 23	Gravel Lift		15320 C.Y./Mi. Maint. Div.	
	C				
1946	A.F.E. 18	Gravel Lift Bit. Surfacing Mixed Bit.	24' 1"	563,422.59284 Gal. Agg. 1804 C.Y.	
	M				
1946	A.F.E. 6	Grav. Lift (Spots) Grav. Resurfacing (Spots)	24' 2'-5"	1812 C.Y.	

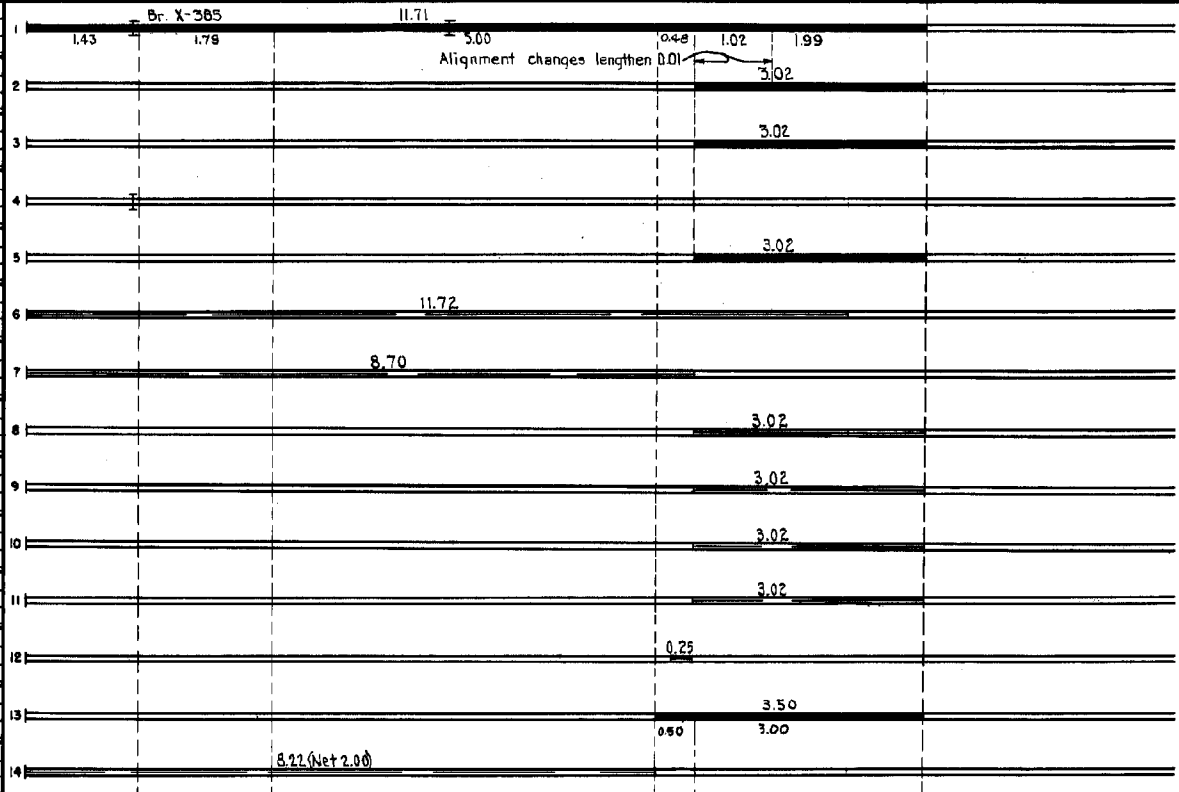

YEARS		TOTAL MILES	UNINCORPORATED		INCORPORATED		RURAL		URBAN	
FROM	TO		RDWY. MI.	BR. MI.	RDWY. MI.	BR. MI.	RDWY. MI.	BR. MI.	RDWY. MI.	BR. MI.
1934	1934	11.71	9.71	0.01	1.99	0.00	11.70	0.01	0.00	0.00
1935	1935	11.72	9.71	0.01	2.00	0.00	11.71	0.01	0.00	0.00
1936	1936	10.18	8.17	0.01	2.00	0.00	10.17	0.01	0.00	0.00
1957	1956	10.18	7.92	0.01	2.25	0.00	10.17	0.01	0.00	0.00
1967		11.68	9.42	0.01	2.25	0.00	11.67	0.01	0.00	0.00

REMARKS: Layout is to scale as of 1935.

(1) Br. 3768 built in 1922. (2) This work not done under this project number but lies within the limits of this project.

PREPARED BY
HIGHWAY PLANNING SURVEY
IN COOPERATION WITH
U. S. PUBLIC ROADS ADMINISTRATION

STATE OF MINNESOTA
DEPARTMENT OF HIGHWAYS
ROAD LIFE STUDIES
CONSTRUCTION PROJECT LOG RECORD

CONTROL SECTION 5808
TRUNK HIGHWAY 18
COUNTY Pine
DISTRICT 1A

LIMITS: W. Co. Line - Jct. T.H. 23

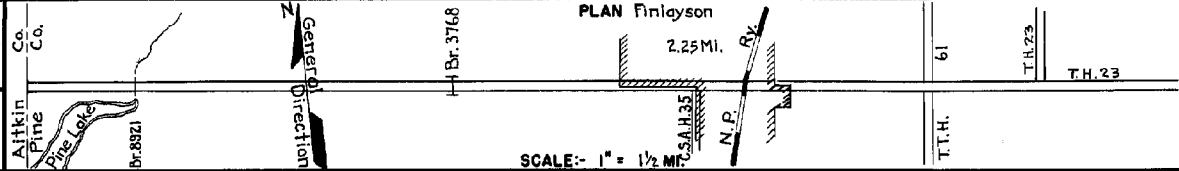

YEAR BUILT	PROJECT NO.	DESCRIPTION			CODE NO.
		TYPE	WIDTH	THICKNESS	
C 1947	A.F.E. 27	Stab. Grav. Base Bit. Surf. Treat. Mixed Prime	26' 24'	12"	SC-3, 69245 Gal.
M 1947	A.F.E. 33	Shoulder Widening			Rdwy. Widened to 30'
M 1949	A.F.E. 4	Bit. Fog Seal	24'		RC-1, 9853 Gal. Agg. 249 C.Y.
M 1951	A.F.E. 6	Grav. Resurfacing	24'		2203 Tons
M 1952	A.F.E. 4	Spot Treat. Bit Surf. Repair	24'		SC-4, 9649 Gal. Agg. 632 C.Y.
M 1953	A.F.E. 604	Spot Treat. Bit Surf. Repair	24'		SC-3, 11989 Gal. Agg. 1204 Tons
M 1953	A.F.E. 606	Regravelling (Spots)			455 Tons
M 1956	A.F.E. 604	Spot Treat. Bit Surf. Repair	24'		SC-3, 9677 Gal. Agg. 952 Tons
C 1956	A.F.E. 826	Bit Surfacing Bit Surf.-Treat.	20'	3/4"	MC-2, 15400 Gal. Agg. 403 Tons (balance salvaged from base)
C 1956	5808-05	Grading Gravel Base Br. 8921 (C1010D)	32'	3"	6" Sand-Gr. Sub-base & 12" Select Granular Mat
C 1957	5808-07	Base * Plant Mix Bit. Br. 3768 (Widen)	24'	1 1/2"	*Upper 1" of Base Imp. Bit. Stabilized 23 C.D.G. (by Br. Crew)
M 1958	A.F.E. 604	Spot Treat. Bit Surf. Repair	24'		SC-3, 4800 Gal. Agg. 381 Tons
C 1959	A.F.E. 825	Sub-grade Correct. Gravel Base Road Mix Bit.	24'		MC-2, 2370 Gal. Agg. 112 Tons Gravel Base 1221 Tons
M 1961		Light Bit Seal	25'		RS-2, 18361 Gal. Agg. 645 Tons

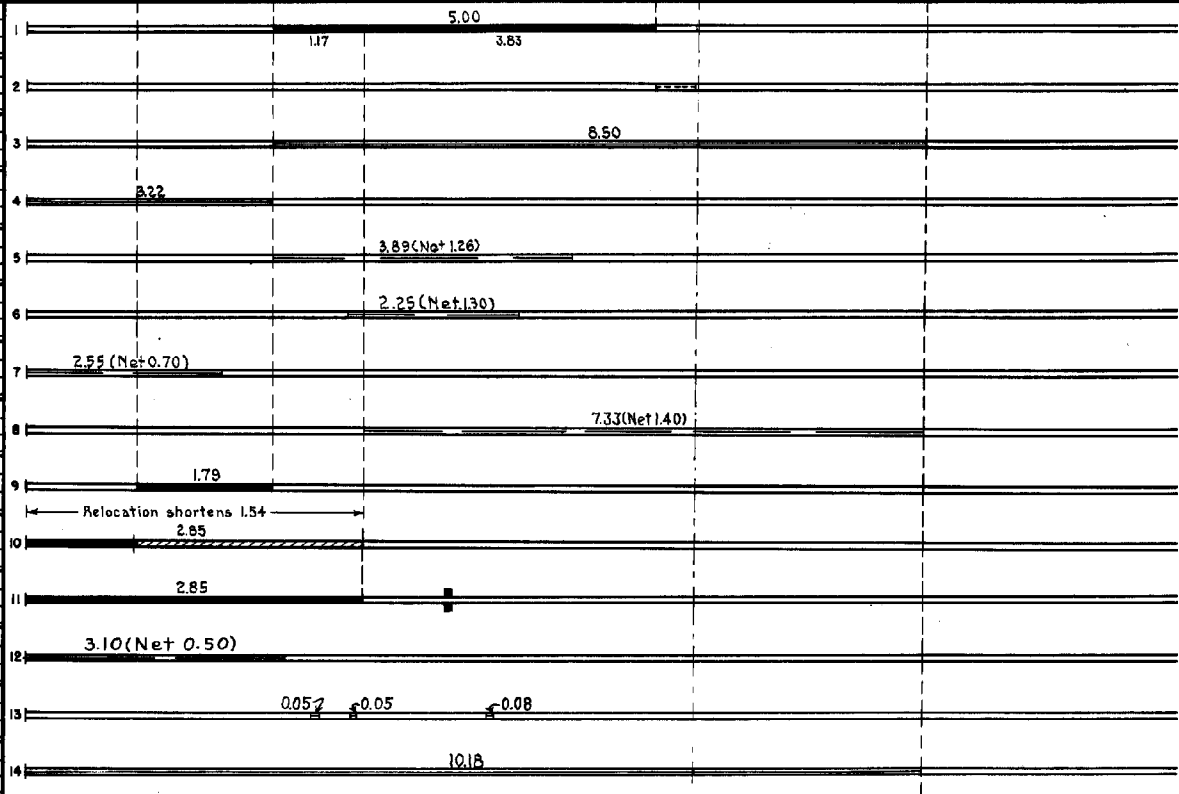

YEARS FROM TO		TOTAL MILES	UNINCORPORATED		INCORPORATED		RURAL		URBAN	
FROM	TO		RDWY. MI.	BR. MI.	RDWY. MI.	BR. MI.	RDWY. MI.	BR. MI.	RDWY. MI.	BR. MI.

REMARKS: See Sheet No. 1

PREPARED BY
TRAFFIC AND PLANNING DIVISION
IN COOPERATION WITH
U.S. DEPARTMENT OF COMMERCE
BUREAU OF PUBLIC ROADS

STATE OF MINNESOTA
DEPARTMENT OF HIGHWAYS
ROAD LIFE STUDIES
CONSTRUCTION PROJECT LOG RECORD

CONTROL SECTION 5808
TRUNK HIGHWAY 18
COUNTY Pine
MAINTENANCE DISTRICT 1A

LIMITS: W. Co. Line - Jct. T.H. 23

Ref. Pt. 068+00.775 - 080+00.516

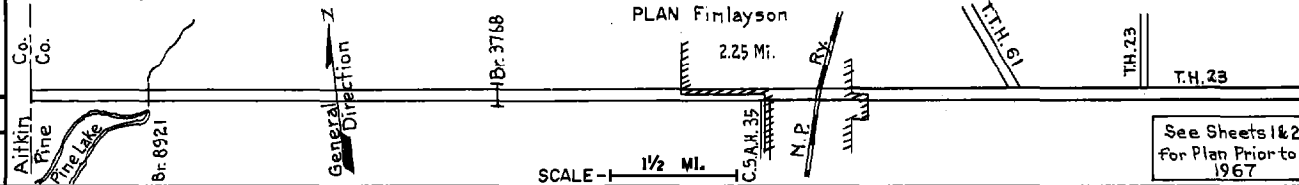

See Sheets 1 & 2
for Plan Prior to
1967

YEAR BUILT	PROJECT NO.	DESCRIPTION			REMARKS
		TYPE	WIDTH	THICKNESS	
M 1962		Spot Treat Bit. Surf. Repair	24'		MC-3, 10230 Gal. Rd. Mix 728 tons
1952 1962	5807-15 5807-22	Plant Mix Bit. 1.34 mi. Plant Mix Bit. 0.16 mi.	24' 48'	2 1/2" 3" 3 1/2"	Transferred from C.S. 5807 T.H. 61 (61=1) in 1967
C 1973	5808-09	Agg. Shoulders Bit. Overlay	2' 24'		1 1/2"
C 1981	5808-12	Bit. Resurfacing Bit. Shoulders	24' 20' 8"	1 1/2" 1 1/2"	
C 1982	5808-14	C.M.P. Replacement and Salvage with R.C.P.			Replace 7 C.M.P. with 7 R.C.P. Pipes
M 1987	SF	Spot Overlay	24'	1 1/2"	Spec. 2331
M 1988	SF	Spot Overlay	24'	1"	Spec. 2341
M 1990	M4416	Bit. Overlay	24'	2"	Spec. 2331
M 1993	M93207	Spot Overlay	Var.	2"	Spec. 2331
C 1993	5808-16	Bit. Overlay Bituminous Agg. Base	24'	Var.	Spec. 2331 Shoulder Work Shoulder Work
M 1998	8821-22	Aggregate Seal			**
S 2000	8821-31	Bituminous Crack Sealing			
S 2001	8821-58	Major Bituminous Crack Sealing			
S 2006	8821-113	Milling Bit. Overlay	24' 24'	2" 4"	Spec. 2360

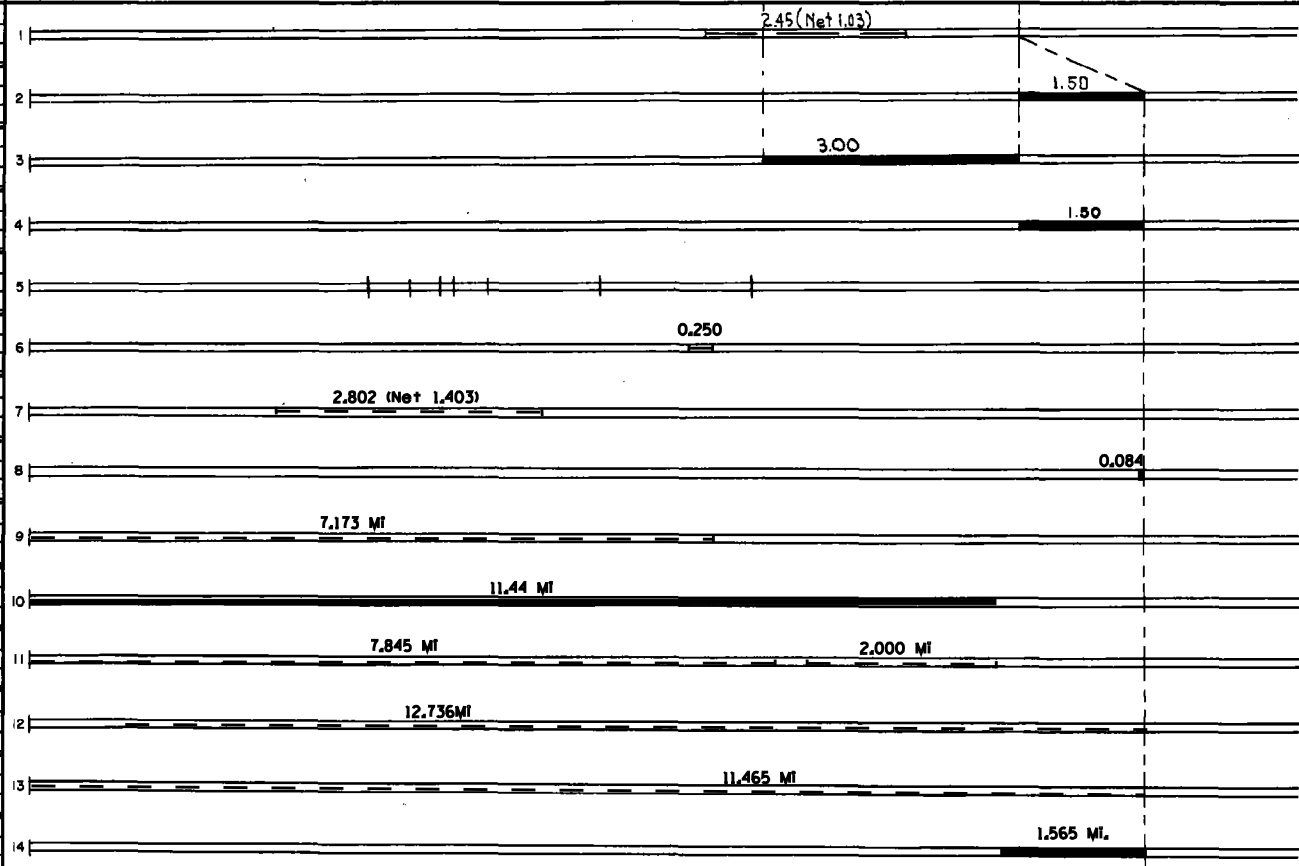

YEARS		TOTAL MILES	UNINCORPORATED		INCORPORATED		RURAL		URBAN	
FROM	TO		RDWY. MI.	BR. MI.	RDWY. MI.	BR. MI.	RDWY. MI.	BR. MI.	RDWY. MI.	BR. MI.

REMARKS: See Sheet No. 1