

PREPARED BY  
HIGHWAY PLANNING SURVEY  
IN COOPERATION WITH  
U.S. PUBLIC ROADS ADMINISTRATION

STATE OF MINNESOTA  
DEPARTMENT OF HIGHWAYS  
ROAD LIFE STUDIES  
CONSTRUCTION PROJECT LOG RECORD

CONTROL SECTION 5810  
TRUNK HIGHWAY 70  
COUNTY Pipe  
DISTRICT 1A

LIMITS: W. Co. Line - Jct. T.H. 61

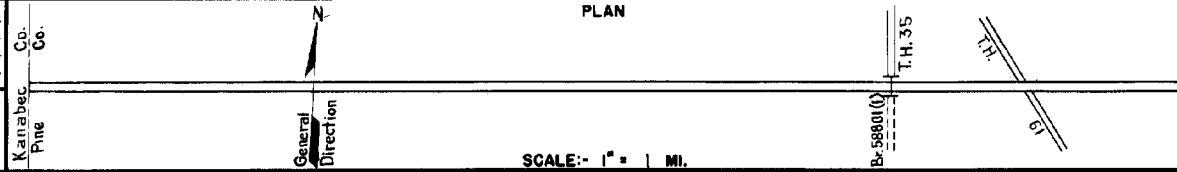

| YEAR BUILT | PROJECT N°      | DESCRIPTION  |                   |               | CODE N°   |
|------------|-----------------|--|-------------------|---------------|---|
|            |                 | TYPE   | WIDTH             | THICK-NESS    |   |
| 1924       |                 | Gravel<br>Br. 2759                                   | 24'<br>18'        | 2"            | Co. Job 2413<br>Added in 1934.<br>17 B.S.                 |
| 1934       |                 | Br. 2759   | 23'               |               | 17 B.S.<br>Widening                                       |
| M          | 1940 A.F.E. 44  | Regraveling  |                   |               | 198 C.Y./Mi.<br>Maint. Dept.                              |
| C          | 1942 5810-01    | Grading<br>Sand Grv. Base                            | 30'<br>30'        | 6"            |   |
| C          | 1942 A.F.E. 7   | Seeding  |                   |               | Seed supplied by<br>R.S.D. (S.P. 5810-03)<br>Maint. Dept. |
| M          | 1943 A.F.E. 6   | Surface<br>Stabilization                             |                   |               | Clay 129 C.Y./Mi.<br>Maint. Dept.                         |
| C          | 1948 5810-04    | Bit Stab Grv. Base<br>Mixed Bit.                     | 26'<br>25'        | 4'-1/2"<br>1" |   |
| M          | A.F.E. 17       | Sag & Dip Remov. (0.07 Mi)                           | 24'               |               | B.C.S. 18563, 14268 Gal.<br>Agg. 431 C.Y.                 |
| 1951       | A.F.E. 4        | Bit. Fog Seal (8.53 Mi)                              | 24'               |               |   |
| M          | 1953 A.F.E. 604 | Spot Treat.<br>Bit. Surf. Repair                     | 24'               |               | MC-2, 4954 Gal.<br>Agg. 386 Tons                          |
| C          | 1954 5810-05    | C.M. Pipe Arch Culv.                                 |                   |               | Replaces Br. 2759   |
| 1925       | 61-1-44-18      | Grading<br>Concrete                                  | 32'<br>18'        |               | Transferred from T.H.<br>61 (C.S. 5805) in 1954           |
| M          | 1955 A.F.E. 604 | Spot Treat.<br>Bit. Surf. Repair                     | 24'               |               | MC-2, 12231 Gal.<br>Agg. 1025 Tons                        |
| C          | 1955 5810-06    | Grading<br>Gravel Base<br>Plant Mix Bit.             | 32'<br>32'<br>24' | 12"<br>2"     |   |
| M          | 1956 A.F.E. 818 | Spot Base Repair<br>Spot Treat.<br>Bit. Surf. Repair | 26'<br>24'        |               | MC-2, 17193 Gal.<br>Agg. 1159 Tons                        |

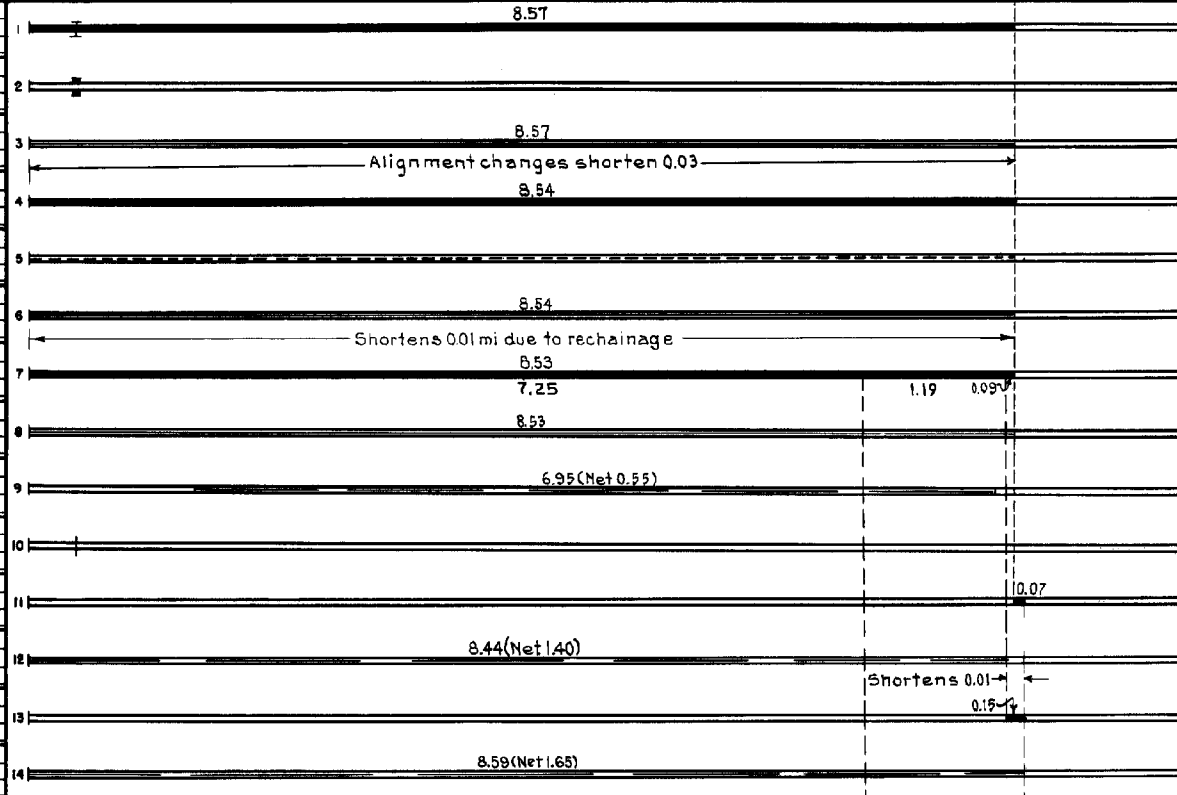

| YEARS FROM | TO   | TOTAL MILES | UNINCORPORATED |         | INCORPORATED |         | RURAL     |         | URBAN     |         |      |
|------------|------|-------------|----------------|---------|--------------|---------|-----------|---------|-----------|---------|------|
|            |      |             | RDWY. MI.      | BR. MI. | RDWY. MI.    | BR. MI. | RDWY. MI. | BR. MI. | RDWY. MI. | BR. MI. |      |
| 1924       | 1941 | 8.57        | 8.57           | 0.00    | 0.00         | 0.00    | 0.00      | 8.57    | 0.00      | 0.00    | 0.00 |
| 1942       | 1947 | 8.54        | 8.54           | 0.00    | 0.00         | 0.00    | 0.00      | 8.54    | 0.00      | 0.00    | 0.00 |
| 1948       | 1953 | 8.53        | 8.53           | 0.00    | 0.00         | 0.00    | 0.00      | 8.53    | 0.00      | 0.00    | 0.00 |
| 1954       | 1954 | 8.60        | 8.60           | 0.00    | 0.00         | 0.00    | 0.00      | 8.60    | 0.00      | 0.00    | 0.00 |
| 1955       | 1963 | 8.59        | 8.59           | 0.00    | 0.00         | 0.00    | 0.00      | 8.59    | 0.00      | 0.00    | 0.00 |
| 1964       |      | 8.62        | 8.59           | 0.03    | 0.00         | 0.00    | 0.00      | 8.59    | 0.03      | 0.00    | 0.00 |

REMARKS: Layout is to scale as of 1934.  
(1) Br. 58801 a 174' Prestressed Girder T.H. 70 over T.H. 35 see C.S. 5880.

PREPARED BY  
HIGHWAY PLANNING SURVEY  
IN COOPERATION WITH  
U.S. PUBLIC ROADS ADMINISTRATION

STATE OF MINNESOTA  
DEPARTMENT OF HIGHWAYS  
ROAD LIFE STUDIES  
CONSTRUCTION PROJECT LOG RECORD

CONTROL SECTION 5810  
TRUNK HIGHWAY 70  
COUNTY Pine  
DISTRICT 1A

LIMITS: M. Co. Line - Jct. T.H. 361

Ref. Pt. 011+00.224 - 019+00.842

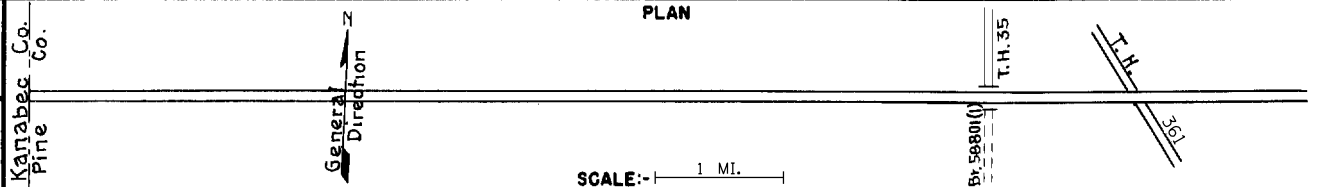

| YEAR BUILT | PROJECT N <sup>o</sup>   | DESCRIPTION   |       |             | CODE N <sup>o</sup> |
|------------|--------------------------|---|-------|-------------|---------------------|
|            |                          | TYPE  | WIDTH | THICKNESS   |                     |
| M<br>1957  | A.F.E. 604               | Spot Treat<br>Bit. Surf. Repair                           | 24'   |             |                     |
| M<br>1958  | A.F.E. 604               | Spot Treat<br>Bit. Surf. Repair                           | 24'   |             |                     |
| M<br>1959  | A.F.E. 604<br>A.F.E. 605 | Spot Treat<br>Bit. Surf. Repair<br>Bit. Seal              | 24'   |             |                     |
| C<br>1964  | 5880-34<br>5880-50       | Grading, Sub-base<br>Gravel & Bit. Base<br>Plant mix Bit. | 24'   | 4 1/2" 3"   |                     |
| C<br>1964  | 5810-08                  | Grading, Sub-base<br>Gravel & Bit. Base<br>Plant mix Bit. | 24'   | 2" 3 1/2"   |                     |
| M<br>1965  | SF                       | Spot Treat<br>Bit. Surf. Repair                           | 24'   | 1"          |                     |
| C<br>1977  | 5810-10<br>SF            | Bit. Surfacing<br>Rt. Turn Lanes<br>Gravel Shoulders      | 24'   | 3-4 1/2" 3" |                     |
| M<br>1996  | M96169                   | Bit. Overlay  | 24'   | 1 1/2"      | Spec. 2331          |
| C<br>1999  | 5810-14                  | Bit. Overlay  | 24'   | 1 1/2"      | Spec. 2350          |
| S<br>2011  | 5810-15                  | Reclamation<br>Milling<br>Bit. Surfacing                  | 24'   | 6" 4" var.  | Spec. 2360          |

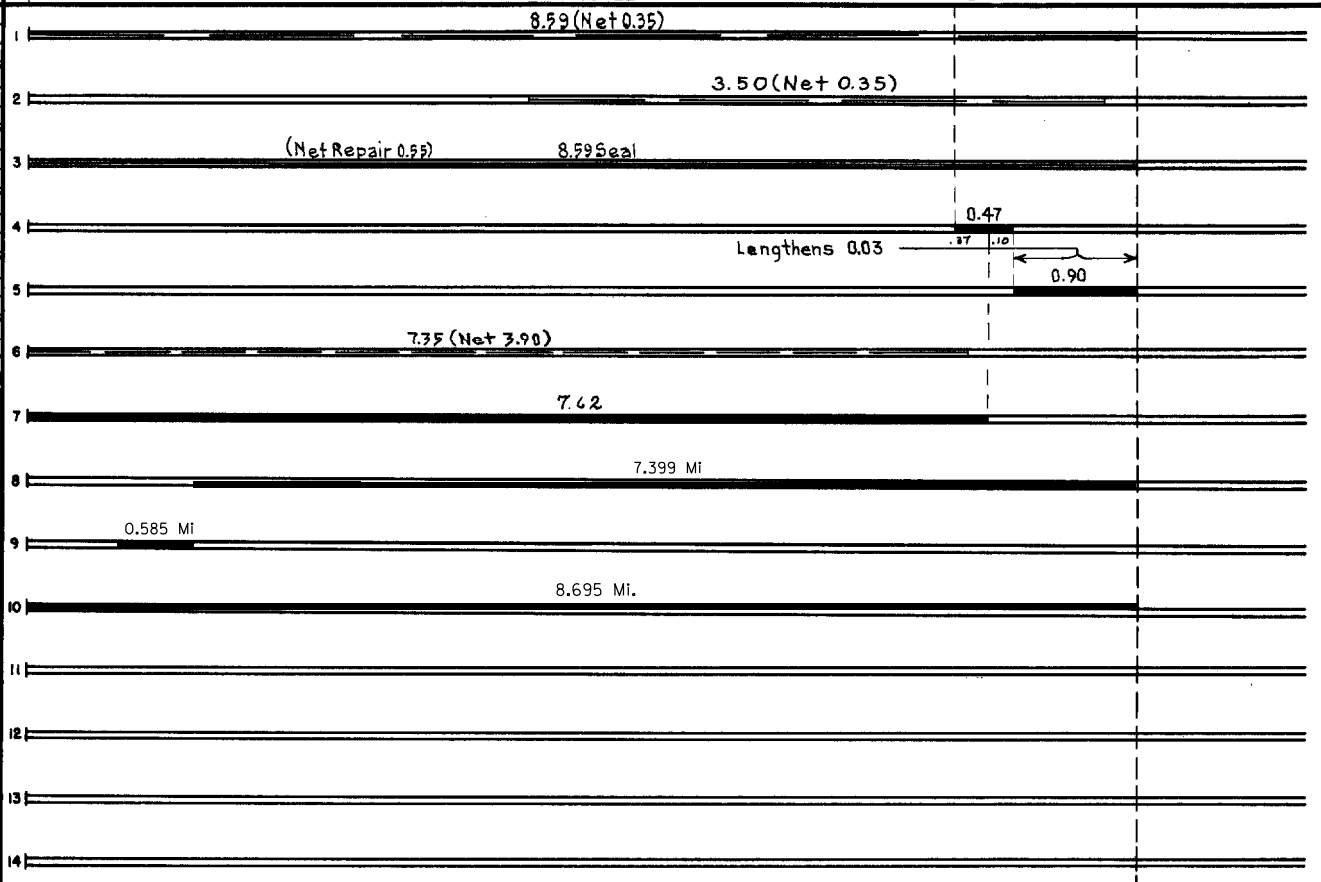

| YEARS |    | TOTAL MILES | UNINCORPORATED |         | INCORPORATED |         | RURAL    |         | URBAN    |         |
|-------|----|-------------|----------------|---------|--------------|---------|----------|---------|----------|---------|
| FROM  | TO |             | ROWY MI.       | BR. MI. | ROWY MI.     | BR. MI. | ROWY MI. | BR. MI. | ROWY MI. | BR. MI. |
|       |    |             |                |         |              |         |          |         |          |         |

REMARKS: See Sheet No. 1