

PREPARED BY
HIGHWAY PLANNING SURVEY
IN COOPERATION WITH
U.S. PUBLIC ROADS ADMINISTRATION

STATE OF MINNESOTA
DEPARTMENT OF HIGHWAYS
ROAD LIFE STUDIES
CONSTRUCTION PROJECT LOG RECORD

CONTROL SECTION 6803
TRUNK HIGHWAY 11
COUNTY Roseau
DISTRICT 2B

LIMITS: E. Junction T.H. 89 at Roseau - State & Lake Sts. in Warrad

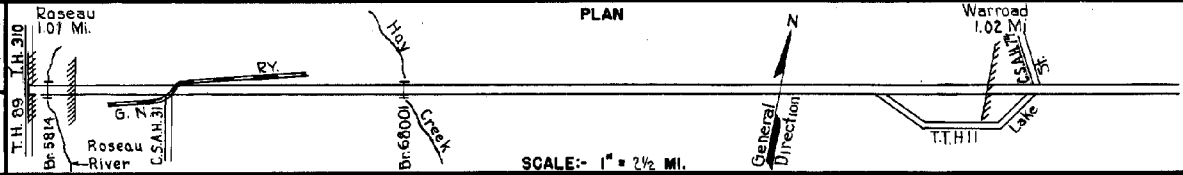

YEAR BUILT	PROJECT N°	DESCRIPTION			CODE N° DIST.
		TYPE	WIDTH	THICKNESS	
		Gravel	28'3"		No Record of Constr.
		Br. M-582	16'		30 B.S.
1924		Gravel	28'3"		Maint. Dept.
		Br. M-204	18'		140 B.S.
1927	11-11-36	Mono. Culv.			Extended 20' Rt. in 1934.
1930		Br. M-204	24'		Br. Widening. 140 B.S. Maint. Dept.
1933		Tar Tr. Gravel	30'		Maint. Dept.
1934	11-11-31	Grading & Gravel Lift	32'		Lift in Spots Only. 433
		Gravel	30'	3"	1000 Ton/Mile. 434
		Br. 5301	27'		30 B.S. 433
1935	11-11-31	Oil Tr. Gravel	26'	1 1/4"	Maint. Dept.
1936	11-11-31	Tar Tr. Gravel	24'	1"	Maint. Dept.
1937	A.F.E. 24	Mixed Bitum.	20'	1 1/4"	Maint. Dept.
1937	A.F.E. 27	Stab. Gravel	N.W. 12" x 18"		Width varies 30'-65' Maint. Dept.
1938	A.F.E. 6	Mixed Bitum.	24'	1"	Maint. Dept.
1939	6803-01	Grading	32'		
		Br. 5814	32'		128 B.S. 1338
1939	A.F.E. 17	Mixed Bitum.	24'	2'-1"	Maint. Dept.
M		Retreat (Spots)			MC&RT, 6171 Gal./Mi.
1942	A.F.E. 4	Fog Seal (Spots)	24'		Grav. 300 C.Y./Mi. Maint. Dept.

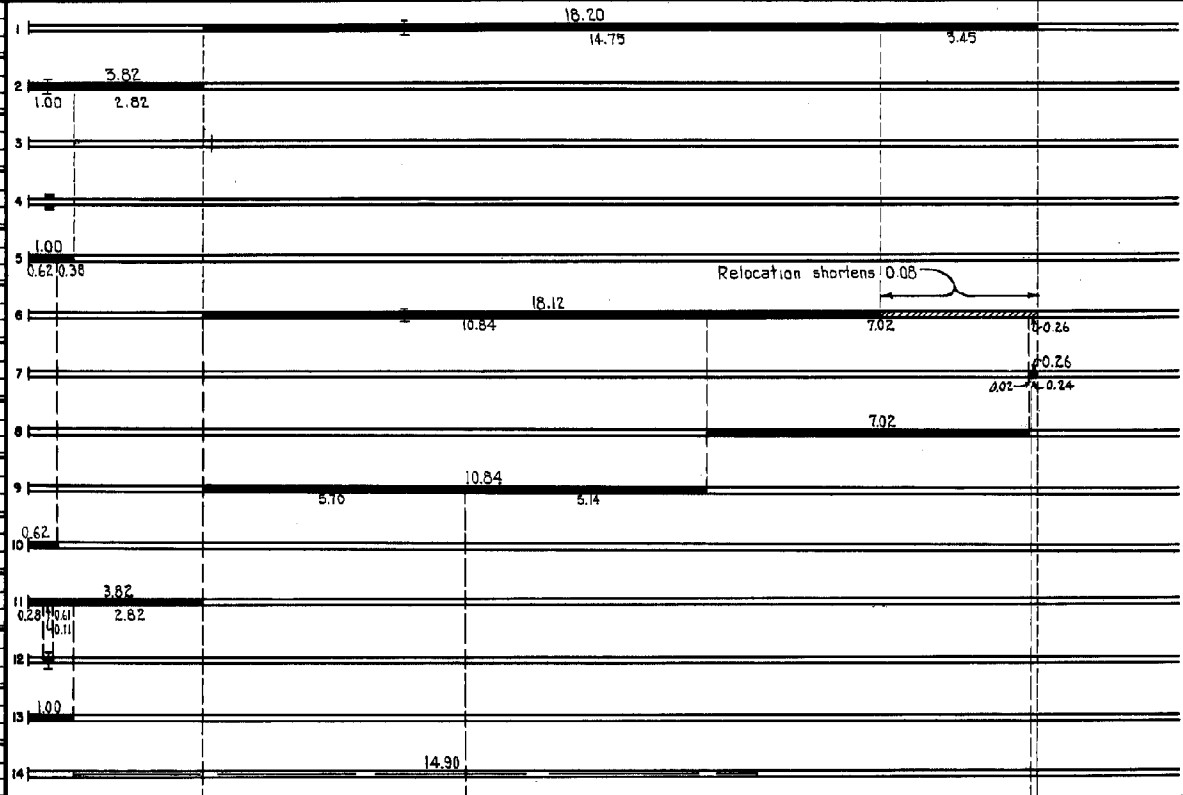

FROM	TO	TOTAL MILES	UNINCORPORATED		INCORPORATED		RURAL		URBAN	
			RDWY. MI.	BR. MI.	RDWY. MI.	BR. MI.	RDWY. MI.	BR. MI.	RDWY. MI.	BR. MI.
1924	1933	22.02	19.11	0.01	2.87	0.03	19.11	0.01	2.87	0.03
1934	1942	21.94	18.91	0.01	2.99	0.03	18.91	0.01	2.99	0.03
1943	1948	21.94	19.91	0.01	1.99	0.03	19.91	0.01	1.99	0.03
1949	1971	21.97	19.94	0.01	1.99	0.03	19.94	0.01	1.99	0.03
1972		21.97	19.93	0.01	2.00	0.03	19.93	0.01	2.00	0.03

REMARKS: Layout is to scale as of 1934.

PREPARED BY
HIGHWAY PLANNING SURVEY
IN COOPERATION WITH
U.S. PUBLIC ROADS ADMINISTRATION

STATE OF MINNESOTA
DEPARTMENT OF HIGHWAYS
ROAD LIFE STUDIES
CONSTRUCTION PROJECT LOG RECORD

CONTROL SECTION 6803
TRUNK HIGHWAY 11
COUNTY Roseau
DISTRICT 28

LIMITS: E. Junction T.H. 89 at Roseau - State & Lake Sts.
In Warroad

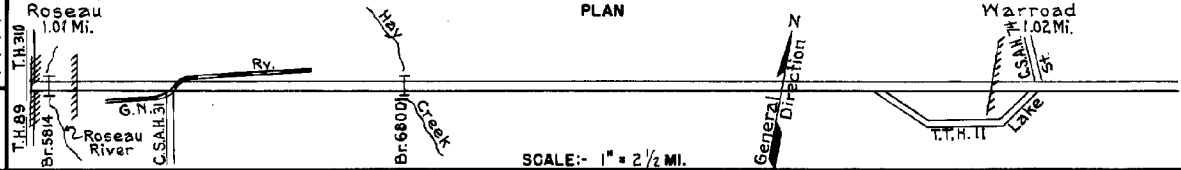

YEAR BUILT	PROJECT N ^o	DESCRIPTION		REMARKS	CODE N ^o
		TYPE	WIDTH THICKNESS		
M 1943	A.F.E. 4	Spot Treat. Bit. Surf. Repair	22'	RT-3153 Gal./Mi. Grav. 99 C.Y./Mi. Maint. Dept.	
M 1944	A.F.E. 4	Spot Treat. Bit. Surf. Repair	24'	RT-6, 2200 Gal./Mi. Agg. 93 C.Y./Mi. Maint. Div.	
M 1945	A.F.E. 4	Spot Treat. Bit. Surf. Repair	24'	SC-3, 1058 Gal./Mi. Grav. 42 C.Y./Mi. Maint. Div.	
M 1945	A.F.E. 4	Bit. Fog Seal		RT-6, 1613 Gal./Mi. Grav. 45 C.Y./Mi. Maint. Div.	
M 1946	A.F.E. 4	Spot Treat. Bit. Surf. Repair & Fog Seal (2.50 Mi.)	24'	SC-3 RT-6, 56094 Gal. Agg. 2763 C.Y.	
M 1947	A.F.E. 4	Bit. Fog Seal	24'	RT-6, 13103 Gal.	
C 1948	6803-04	Sand-Grav. Base Bit. Stab. Base (Mixed Bit)	32' 6" 2"		948
M 1948	A.F.E. 4	Spot Treat. Bit. Surf. Repair	24'	RT-6 & SC-3, 15001 Gal. Agg. 104 C.Y.	
C 1949	6803-02	Gravel Base Bit. Stab. Base (Mixed Bit)	32' 10" 2"		
M 1949	A.F.E. 4	Bit. Fog Seal	24'	MC-3, 17497 Gal. Agg. 315 C.Y.	
C 1950	6803-06	Plant Mix Bit.	24' 1 1/2"	10' Widening for 0.12 mi. on Rt.	1450
C 1950	6803-07	Gravel Base Bit. Stab. Base (Mixed Bit)	32' 6" 2"		1550
C 1953	6803-09	Spot Pl. Mix Lev. Course Plant Mix Bit.	32' 24' 1 1/2"		1853
C 1953	6803-08	Grading Bit. Stab. Base Plant Mix Bit.	32' 18" 3"		1853

LINE	WIDTH	THICKNESS	REMARKS	NET REPAIR	REMARKS
1				21.94	
2				20.94	
3			15.00		
4				6.00	
5				21.94 (Net Repair 7.30)	
6				18.12	
7		5.70			
		3.58	0.12		
8				5.77 (Net 1.90)	
9	3.85		Relocation lengthens 0.03		
10				12.65	
11	1.01	9.43		10.12	
		8.42			
12				12.06	
				12.02	0.04
13				12.02	
14					0.28

YEARS FROM	TOTAL TO	UNINCORPORATED		INCORPORATED		RURAL		URBAN	
		RDWY. MI.	BR. MI.	RDWY. MI.	BR. MI.	RDWY. MI.	BR. MI.	RDWY. MI.	BR. MI.

REMARKS: See Sheet No. 1

PREPARED BY
HIGHWAY PLANNING SURVEY
IN COOPERATION WITH
U.S. PUBLIC ROADS ADMINISTRATION

STATE OF MINNESOTA
DEPARTMENT OF HIGHWAYS
ROAD LIFE STUDIES
CONSTRUCTION PROJECT LOG RECORD

CONTROL SECTION 6803
TRUNK HIGHWAY 11
COUNTY Roseau
DISTRICT 2B

LIMITS: E. Jct. MNTH-89, MNTH-310 - Jct. CSAH-74

Ref. Pt. 070+00.679 - 092+00.689

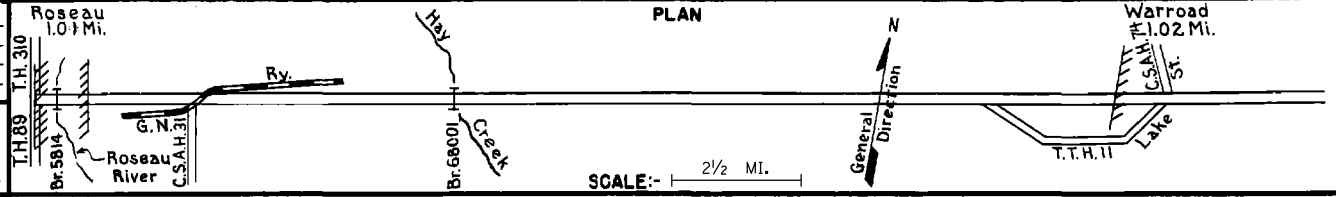

YEAR BUILT	PROJECT N°	DESCRIPTION				CODE N° DIST
		TYPE	WIDTH	THICKNESS	REMARKS	
M&C						
1956	A.F.E. 605 6803-11	Light Bit Seal Traffic Signals	24'		RC-2 & RT-4, 18724 Gal. Agg. 689 C.Y.	1656
C						
1962	6803-12	Plant Mix Bit.	56'	2"		661
C						
1970	6803-16	Pl. Mix. Bit Surf Shoulder Widening Br. 68001	24'	1 1/2" - 4"	Remove Br. 5301 81.2' P.C.	849
C						
1970	6803-18	RR CROSSING SIGNALS			COOP. AGREE.	370 1571
M						
1983	6803-21	Grading Bit. Shoulders	19'	2"	Bit. Spec. 2331	
C						
1983	6803-22	Grading Bit. Shoulders	8'	3"	Bit. Spec. 2331 Rt & Lt.	
C						
1987	6803-25	Bit. Overlay	Var.	1" 1 1/2"	Spec. 2331 Spec. 2341	
C						
1989	6803-28	Grading Bit. Surfacing	65'	6 1/2" 1 1/2"	Spec. 2331 Spec. 2341	
C						
1991	6803-32	Bit. Overlay	24'	1 1/2"	Spec. 2341	
M						
2002	6803-36	Bit. Overlay	24'	1 1/2"	Spec. 2360	
S						
2006	6803-38	Grading, Subcut, Bit Storm Sewer, Curb & G. Lighting & Sig	24'	7"	Spec. 2360	
S						
2008	6803-37	Milling Bit. Overlay	24'	1 1/2" 1 1/2"	Spec. 2360	
C						
2010	6803-41	Grading Bit. Surfacing Agg base C6	24'	6" 12"	Spec. 2360 Agg Shldr's var. Class 1	
2016	8822-192	CL Rumble Strips				

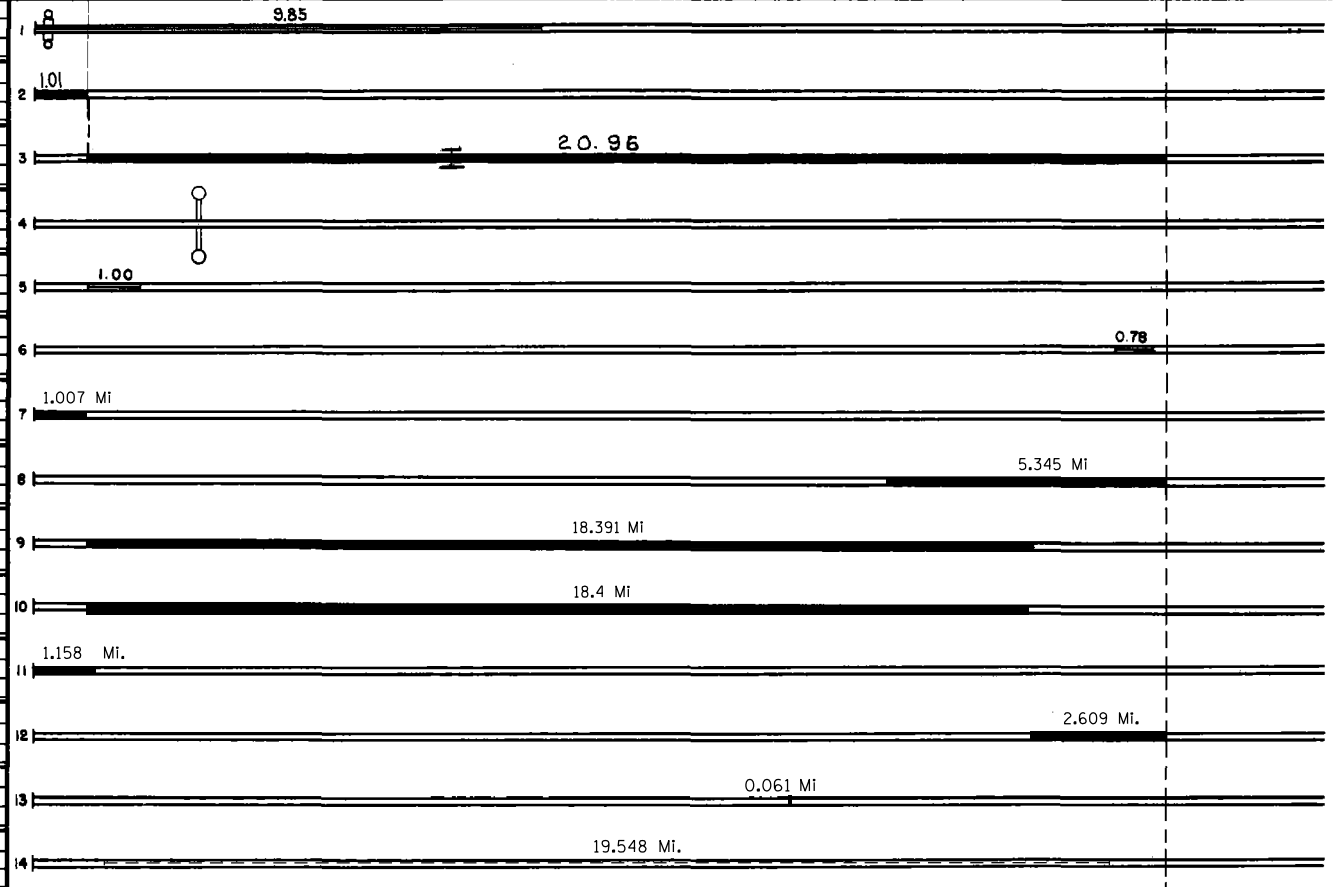

YEARS FROM	YEARS TO	TOTAL MILES	UNINCORPORATED		INCORPORATED		RURAL		URBAN	
			RDWY. MI.	BR. MI.	RDWY. MI.	BR. MI.	RDWY. MI.	BR. MI.	RDWY. MI.	BR. MI.

REMARKS: See Sheet No. 1