

LIMITS: (In Duluth) E. Jct. T.H. 53 (Trinity Road) - Jct. T.H. 23
(6th Ave. E. & 2nd St.)
Ref. Pt. 013+00.569 - 016+00.875

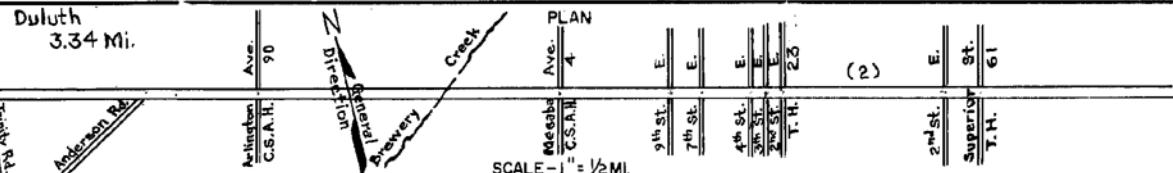

YEAR BUILT	PROJECT NO.	DESCRIPTION				REMARKS
		TYPE	WIDTH	THICKNESS		
	(1)	Oiled Earth Sandstone Block Concrete			Entered System in 1934	
		Inplace Culv.			W 55' 6" Span	
C 1938	6933-01	Grading Widening (New Lane)	Var.			
C 1939	6930-02	Agg. Base Mixed Bit Surf	28'	1'-9"		
C 1940	6933-07	Agg. Base P.C. Concrete	28'	1'-11/2"	Grading on 6933-03	
C 1942	6933-11	Grading, Gravel Base P.C. Conc. Gravel Shoulders	28'	6"	N.B. Rdwy only 5' Rt. & 10' Lt.	
M 1943	AFE 9	Shoulders			23 Tons of CaCl ₂ applied	
M 1944	AFE 30	Bit Surf Repair	21'-42"	1/2"		
C 1946	6933-18	Conc. Base Asphaltic Conc.	2@22'	6" 2 1/2"	Divided Highway	
M 1949	AFE-31	Base Gravel Asphaltic Conc.	6'-30 1/2"	6" 2"	6' Rt. & Lt of Conc. inplace	
C 1952	6933-27	Conc. Rdwy. Inplace Plant Mix Bit. Gravel Shoulders	2@22'	9'-6-9" 3'	5' inside 10' outside	
C 1954	6933-24-28	Conc. Base Widening Asphaltic Conc. Asphaltic Conc.	44-48' 44-48' 42-44'	7" 3" 1'-1 1/4"	Old Conc. Inplace 9th St. to 2nd St. E.	
C 1961	6933-	Old P.C. Conc. Inplace Asphaltic Conc.	28'-37'	6" 1 1/4"	0.09 on N.B. T.H. 194	
M 1964	Maint. Proj. 6933-41	Base Repair Asphaltic Conc. Traffic Signals	42'	1 1/2"		

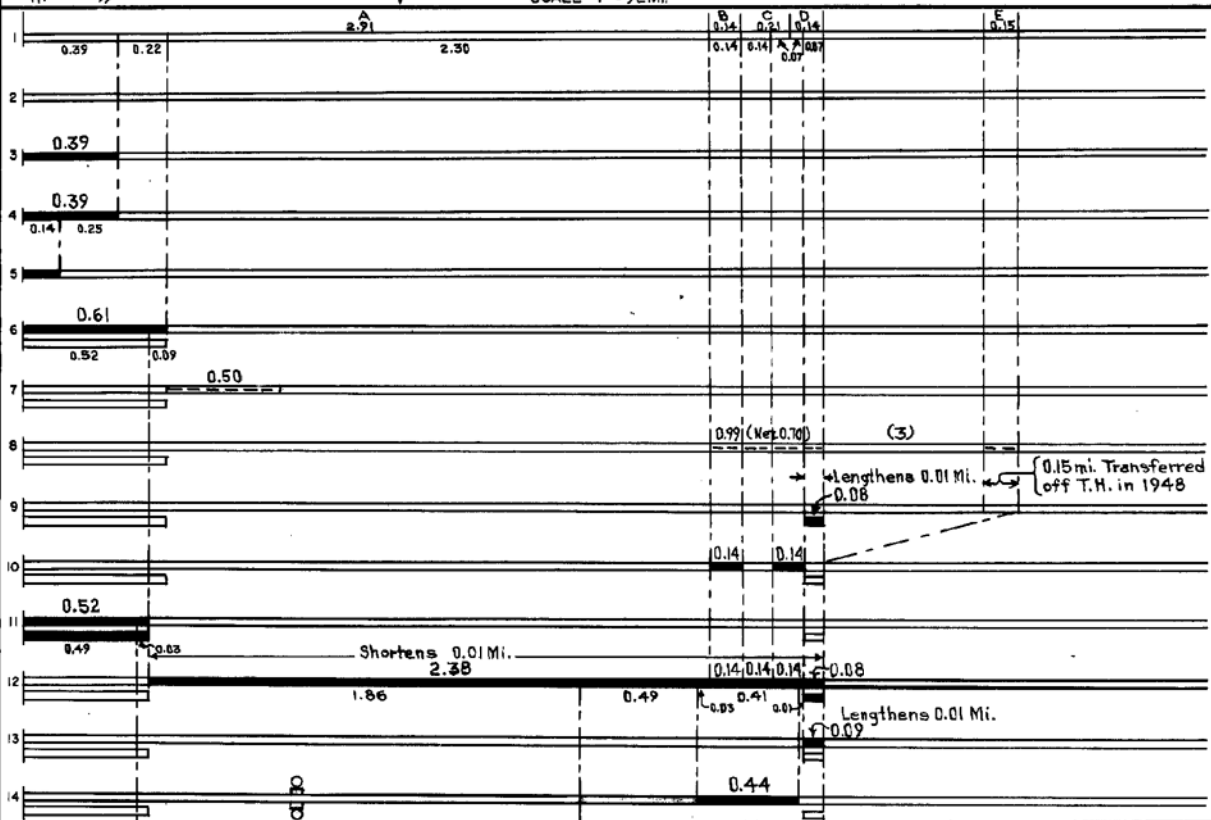

YEARS		TOTAL MILES	UNINCORPORATED		INCORPORATED		RURAL		URBAN	
FROM	TO		RDWY. MI.	BR. MI.	RDWY. MI.	BR. MI.	RDWY. MI.	BR. MI.	RDWY. MI.	BR. MI.
1934	1948	3.55	0.00	0.00	3.55	0.00	0.00	0.00	3.55	0.00
1948	1954	3.41	0.00	0.00	3.41	0.00	0.00	0.00	3.41	0.00
1954	1961	3.40	0.00	0.00	3.40	0.00	0.00	0.00	3.40	0.00
1961	1968	3.41	0.00	0.00	3.41	0.00	0.00	0.00	3.41	0.00
1968		3.34	0.00	0.00	3.34	0.00	0.00	0.00	3.34	0.00

REMARKS: Layout to scale as of 1969.
 (1) Surface entered in 1934: A- conc. built 1929 (2.91 mi.); B- Sandstone block, built 1929 (0.14 mi.);
 C- conc. built 1917 (0.21 mi.); D- Oiled earth, year unknown (0.14 mi.); E- Sandstone block, built 1927 (0.15 mi.)
 (2) 0.35 mi. from 6th Ave. E. to 2nd Ave. E. on C.S. 6945; 0.09 mi. from Mesaba Ave & 1st St. on 2nd St. to 2nd Ave. E.
 on C.S. 6945.
 (3) Includes that portion of T. 25 from 6th Ave. E. to 2nd Ave. E. C.S. 6945.

PREPARED BY
TRAFFIC AND PLANNING DIVISION
IN COOPERATION WITH
U.S. DEPARTMENT OF COMMERCE
BUREAU OF PUBLIC ROADS

STATE OF MINNESOTA
DEPARTMENT OF HIGHWAYS
ROAD LIFE STUDIES
CONSTRUCTION PROJECT LOG RECORD

CONTROL SECTION 6933
TRUNK HIGHWAY 194
COUNTY St. Louis
DISTRICT 1A1

LIMITS: (In Duluth) E. Jct. T.H. 53 (Trinity Road) - Jct. T.H. 23
(6th Ave E. & 2nd St.)

Ref. Pt. 013+00.569 - 016+00.875

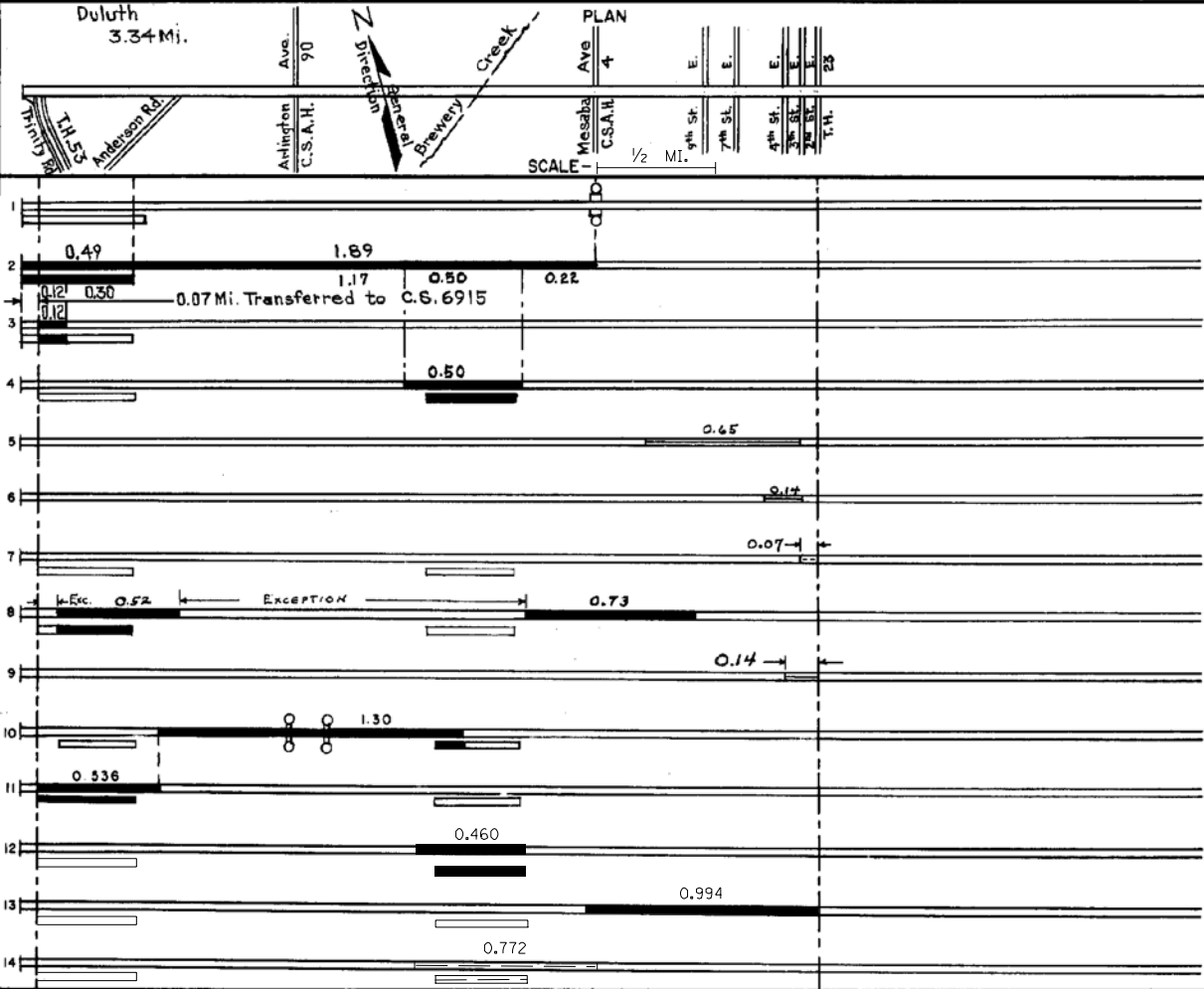

YEAR BUILT	PROJECT NO	DESCRIPTION				REMARKS
		TYPE	WIDTH	THICKNESS		
C	6933-40	Turn Lanes, Lighting Channelization Traffic Signals				Jct. of Central Ent and Mesaba Ave.
1966	Maint. Proj.	Plant. Mix Bit. Shape Shoulders	44-48	1 1/2"		0.49 Divided
C	6915-60	Asphaltic Conc.	20'22"	1 1/2"		0.07 Mi. Transferred to C.S. 6915
C	6933-50					
1971	T 5101 (002)	ASPHALTIC CONC. WIDENING	20'28"	2 3/4"		0.34 MI. DIVIDED
M	6933-57	CURB & GUTTER CONC. SIDEWALK & STORM DRAINAGE REPAIR			4"	
M	6933-58	ASPH. CONC. REPAIR	41'	3/8"		CURB TO CURB
C	6933-51	TRAFFIC CHANNELIZATION				
C	6933-53	BIT. OVERLAY, TURN LANE EXTENSIONS, CONST. TURN LANES & SHOULDER	44 1/2'	1 1/2"		FROM C.S. 13 TO 97th St. E. IN DULUTH
C	6933-58	ASPH. CONC. REPAIR	41'	3/8"		ASPH. CONC. #1861 165 Ton SF
C	6933-64	Grading, Surfacing, C&G, Signals & Bike Path	Var. 24'	1"		Signals at Arlington & Rosewood Bit. Spec. 2361 Shldr. Spec. 2361
C	6933-67	App. & Bit. Base Bit. Surface Bit. Shoulders	2-30' 2-24' 10' 3'	13 1/2" 2 1/2" 2"		
C	6933-69	Grading Bit. Surfacing	Var.	7" 1"		Spec. 2331 Spec. 2361
C	6933-73	Grading Conc. Surfacing	Var.	8"		
M	M4534	Crack Repair				

YEARS		TOTAL MILES	UNINCORPORATED		INCORPORATED		RURAL		URBAN	
FROM	TO		RDWY. MI.	BR. MI.	RDWY. MI.	BR. MI.	RDWY. MI.	BR. MI.	RDWY. MI.	BR. MI.

REMARKS: See sheet No. 1.

PREPARED BY
BUREAU OF POLICY & PLANNING
IN COOPERATION WITH
U.S. DEPARTMENT OF TRANSPORTATION - FEDERAL HIGHWAY ADMINISTRATION

STATE OF MINNESOTA
DEPARTMENT OF TRANSPORTATION
CONSTRUCTION PROJECT LOG RECORD

CONTROL SECTION 6933
TRUNK HIGHWAY 194
COUNTY St. Louis
DISTRICT IA

LIMITS: NB Jct. USTH-53 xing - Jct. I-35
Ref. Pt. 013+00.569 - 017+00.381

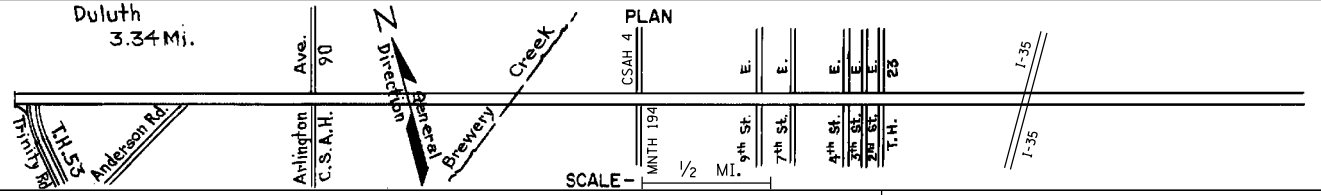

YEAR BUILT	PROJECT No	DESCRIPTION			
		TYPE	WIDTH	THICKNESS	REMARKS
1995	6933	Control Section Relocation			Effective date November 1, 1995
M					
1997	6933-78	Aggregate Seal			
C					
1999	6933-79	Milling Bit. Overlay	Var.	2"	Spec. 2350
C					
2000	6933-81	Milling Bit. Overlay	24'	3"	Spec. 2350
M					
2000	8821-31	Bituminous Crack Sealing			
M					
2001	8821-58	Major Bituminous Crack Sealing			EB & WB
C					
2001	6914-104	Grading, Bit Surface	24'	7"	
C					
2002	6933-77	Subgrade, Grading Aggregate Base Concrete	24'	Var. 5" 8"	Class 5
C					
2004	6933-82	Milling Bituminous	24'	4"	Spec 2360
C					
2009	6833-88	Milling Bit. Overlay	var.	4"	Spec. 2360
C					
2012	6933-89	Milling Bit. Overlay Rumble Strips	24'	3"	Spec. 2360
C					
2015	6933-90	Milling & Bit. Overlay Pymt Resurf. & Rehab.	24'	3" 1.5"	Spec. 2360
C					
2018	6933-95	Grading as built Bituminous Mill Concrete Surf.	var.	6" 4"	agg. base cl.5 lane reconfig. ADA & rehab. Br.69839
C					
2018	6933-97	Grading as built Bituminous Mill 2" Concrete Surf.	var.	3" 6" 8"	agg. base cl.5 & ADA C/G CPR Full depth repair

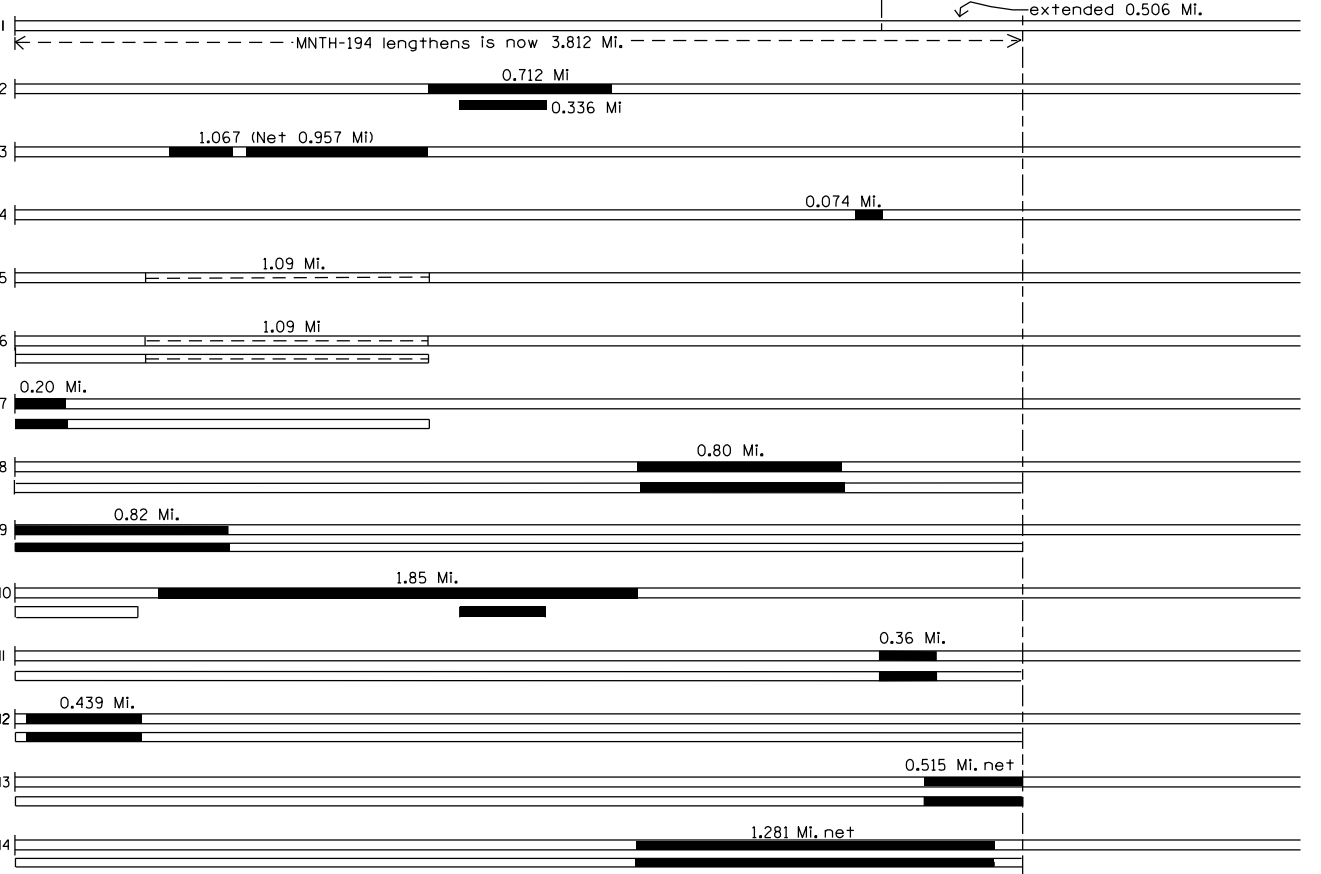

YEARS FROM	TO	TOTAL MILES	UNINCORPORATED		INCORPORATED		RURAL		URBAN	
			RDWY. MI.	BR. MI.	RDWY. MI.	BR. MI.	RDWY. MI.	BR. MI.	RDWY. MI.	BR. MI.

REMARKS: