

PREPARED BY
HIGHWAY PLANNING SURVEY
IN COOPERATION WITH
U.S. PUBLIC ROADS ADMINISTRATION

STATE OF MINNESOTA
DEPARTMENT OF HIGHWAYS
ROAD LIFE STUDIES
CONSTRUCTION PROJECT LOG RECORD

CONTROL SECTION 7902
TRUNK HIGHWAY 60
COUNTY Wabasha
DISTRICT 6B

LIMITS: W.Co. Line at Mazeppa - Jct. T.H. 63 in Zumbro Falls

Ref. Pt. 186+00.678 - 193+00.975

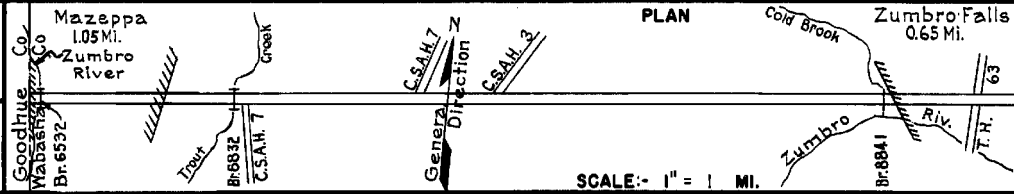

YEAR BUILT	PROJECT N°	DESCRIPTION			CODE N°	
		TYPE	WIDTH	THICKNESS		
		Gravel	24'	2"	No Record of Constr. Added in 1934.	
		Br. 3524	19'		164 C.D.G.	
		Tar Tr. Gravel	40'	1 1/2"	No Record of Constr. Added in 1934.	
		Gravel	24'	3"-4"	No Record of Constr. Added in 1934.	
		Br. 6184, 6183 & 85	15'		70 L.T. 90 BS. A.L.T. & 10 BS.	
		Oil Tr. Gravel	40'		No Record of Constr. Added in 1934.	
1938	A.F.E. 26	Channel Change			Maint. Dept.	
1938	A.F.E. 34	Reshaping Gravel	30'	24'	1 1/2"	Maint. Dept.
1939	A.F.E. 28	Br. 85 Removed			Replaced by 2-48" C.M.	
C	1940	A.F.E. 12	Crushed Rock	24'	1 3/4"	Maint. Dept.
C	1943	A.F.E. 4	Bit. Surf. Treat.	62'	3/4"	Maint. Dept.
M	1946	A.F.E. 6	Cr. Rock Resurfacing	24'		5592 C.Y.
C	1947	A.F.E. 24	Bit. Resurfacing	24'	3/4"	MC-3,9099 Gal. Agg. 247 tons.
C	1948	7902-02	Grading	36'		Not used until 1952
C	1948	7902-02	Stab. Gravel	32'	2	1200 C.Y./MI.
C	1949	A.F.E. 27	Bit. Surfacing	20'	1 1/2"	(1)
M	1950	A.F.E. 4	Light Bit. Seal	24'		RC-1, 1910 Gal. Agg. 64 C.Y.

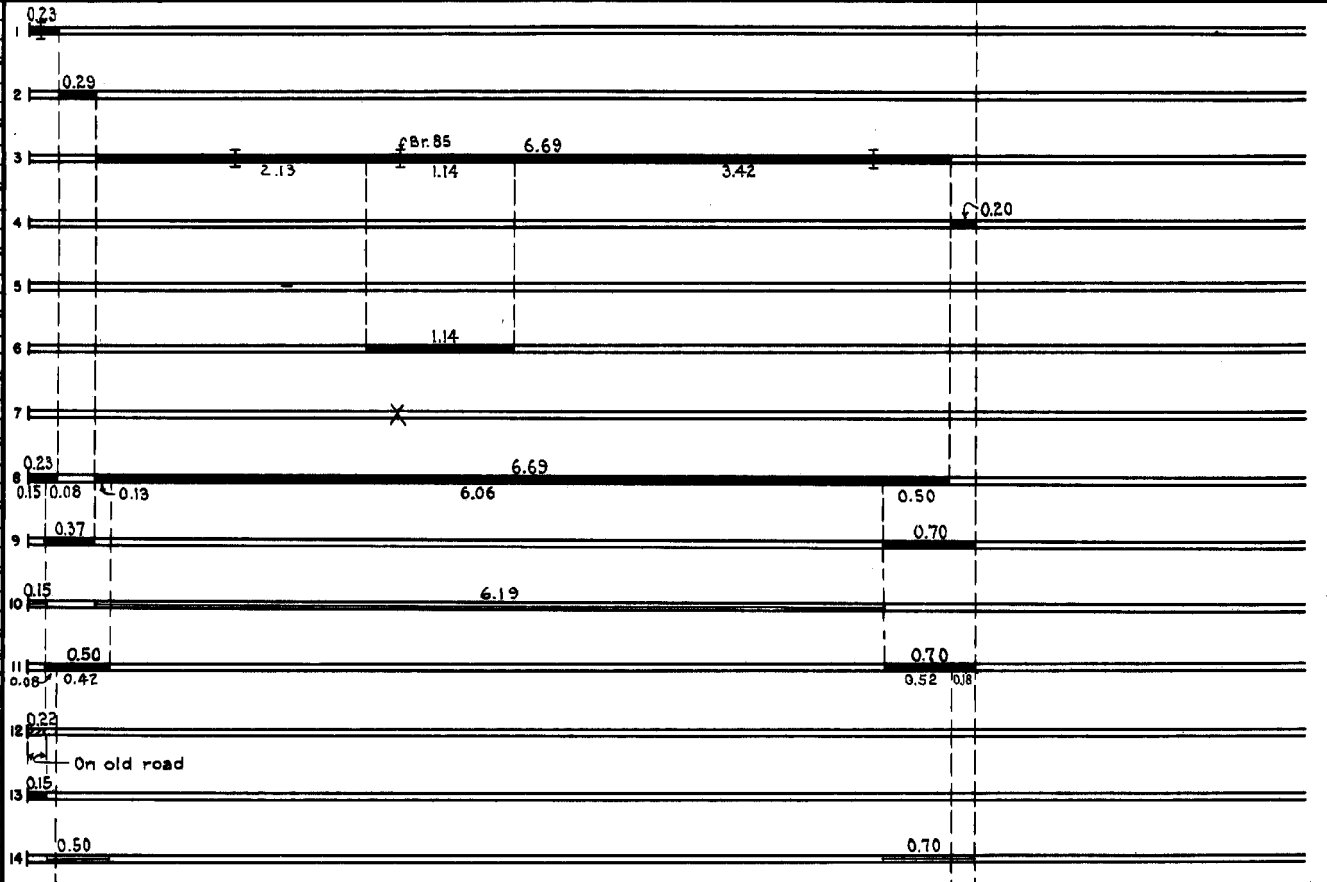

YEARS FROM	TO	TOTAL MILES	UNINCORPORATED		INCORPORATED		RURAL		URBAN	
			RDWY. MI.	BR. MI.	RDWY. MI.	BR. MI.	RDWY. MI.	BR. MI.	RDWY. MI.	BR. MI.
1934	1951	7.41	5.68	0.03	1.69	0.01	7.37	0.04	0.00	0.00
1952	1953	7.64	5.68	0.03	1.89	0.04	7.57	0.07	0.00	0.00
1954		7.28	5.58	0.02	1.66	0.04	7.22	0.06	0.00	0.00

REMARKS: Layout is to scale as of 1934.
(1) This work performed by Maint. District 13, see C.S. 2512 for quantities.

PREPARED BY
HIGHWAY PLANNING SURVEY
IN COOPERATION WITH
U.S. PUBLIC ROADS ADMINISTRATION

STATE OF MINNESOTA
DEPARTMENT OF HIGHWAYS
ROAD LIFE STUDIES
CONSTRUCTION PROJECT LOG RECORD

CONTROL SECTION 7902
TRUNK HIGHWAY 60
COUNTY Wabasha
DISTRICT 65

LIMITS: W. Co. Line of Mazeppa - Jct. T.H. 63 in Zumbro Falls
Ref. Pt. 186+00.678 - 193+00.975

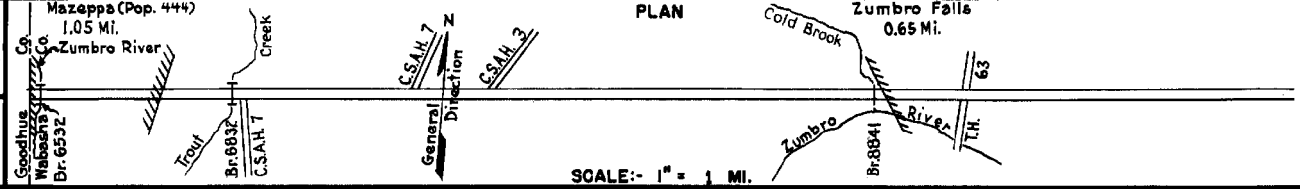

YEAR BUILT	PROJECT N°	DESCRIPTION			CODE N°
		TYPE	WIDTH	THICKNESS	
M	1950 A.F.E. 6	Gravel & Cr. Rock Resurfacing (Spots)	24'		1
M	1951 A.F.E. 6	Grav. Resurfacing	25'		2
C	1952 7902-03 A.F.E. 26	Br. 6532 Br. Appr. Lifts	30'		3
C	1952 A.F.E. 25	Bit. Surfacing Mixed Bit.	24'	1"	4
M	1953 A.F.E. 604 A.F.E. 605	Spot Treat. Bit Surf. Repair Spot Seal Coat (0.47 Mi.)	24'		5
C	1953 7902-08	Sand-Grav. Sub-base Gravel Base Plant Mix Bit.	32' 32' 24'	9" 3" 1 1/2"	6
C	1954 7902-04 (2) 7902-09	Grading Gravel Br. 6832 (120' B.S.)	30' 30'	2 1/2" 3"	7
C	1955 7902-11	Stab. Grav. Base Plant Mix Bit.	28' 24'	4" 9" 1 1/2"	8
C	1956 7902-10	Sand-Grav. Sub-base Cr. Rock Base Plant Mix Bit.	44' 44' 44'	12" 6" 3"	9
M	1956 A.F.E. 605	Bit. Seal Coat	24'		10
C	1957 A.F.E. 866 1958 A.F.E. 866	Erosion Control			11
M	1961	Light Bit. Seal	46'		12
M	1964 SF	Spot Treat Bit. Surf. Repair	24'		13
M	1965 SF	Spot Treat Bit. Surf. Repair	24'	3/4"	14

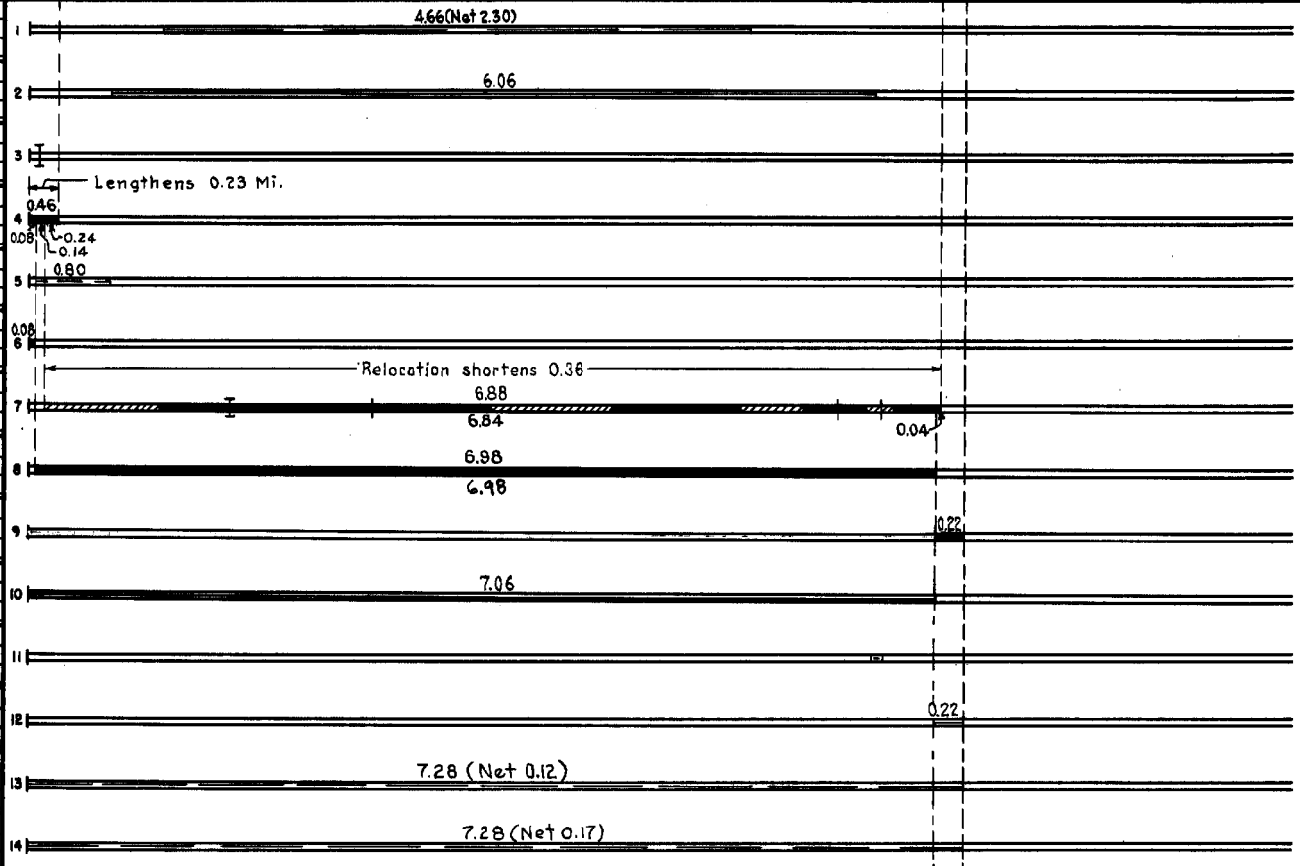

YEARS		TOTAL MILES	UNINCORPORATED		INCORPORATED		RURAL		URBAN	
FROM	TO		RDWY. MI.	BR. MI.	RDWY. MI.	BR. MI.	RDWY. MI.	BR. MI.	RDWY. MI.	BR. MI.

REMARKS: See Sheet No. 1
(2) Contract not final but work substantially complete on S.P. 7902-04. (3) On entrance

PREPARED BY
TRAFFIC AND PLANNING DIVISION
IN COOPERATION WITH
U.S. DEPARTMENT OF COMMERCE
BUREAU OF PUBLIC ROADS

STATE OF MINNESOTA
DEPARTMENT OF HIGHWAYS
ROAD LIFE STUDIES
CONSTRUCTION PROJECT LOG RECORD

CONTROL SECTION 7902
TRUNK HIGHWAY 60
COUNTY Wabasha
DISTRICT 4B

LIMITS: W. Co. Line at Mazzeppa - Jct. T.H. 63 in Zumbro Falls
Ref. Pt. 186+00.678 - 193+00.975

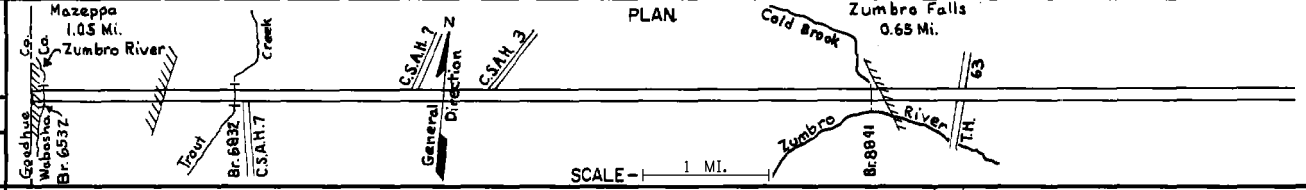

YEAR BUILT	PROJECT NO	DESCRIPTION			
		TYPE	WIDTH	THICKNESS	REMARKS
M 1966	C	Light Bit Seal	25'		CRS-1, 13696 Gal. FA-1, Agg. 450 C.Y.
M 1967	C	Light Bit Seal	25'		CRS-1, 6290 Gal. FA-1, Agg. 262 C.Y.
M 1969	SF	Spot Bit Seal Coat	24'		RC 800 1300 Gal. Agg. 50 C.Y.
M 1972	SF	Spot Bit Repair	24'	1/2"	RC-800 3850 Gal. Agg. 201 Tons
C 1975	-13	Pl. Mix Bit Surf Gravel Shldr.	24'	2 1/2" 2'-4"	
M 1975	SF	Bit Spot Overlay	24'	1"	AC-1 2331 196 Ton RC 800 Task 175 Gal.
M 1977	SF	Widen Surf on Curves	2'	4"	AC-1 2331 60 Ton
M 1977	SF	Restore Agg. Shldr.	3'	1'-2"	Agg. 1672 Ton
M 1984	7902 SF	Erosion Control At Br. 6832			
M 1988	SF	Bit. Sealing			
M 1995	7902-95196	Bit. Overlay	24'	1 1/2"	Spec. 2341
S 2002	7902-18	Milling Bit. Overlay	24'	3"	Spec 2350
M 2004	8826-34	Crack Seal Bit			
S 2007	7902-20	Bit. Seal Coat			

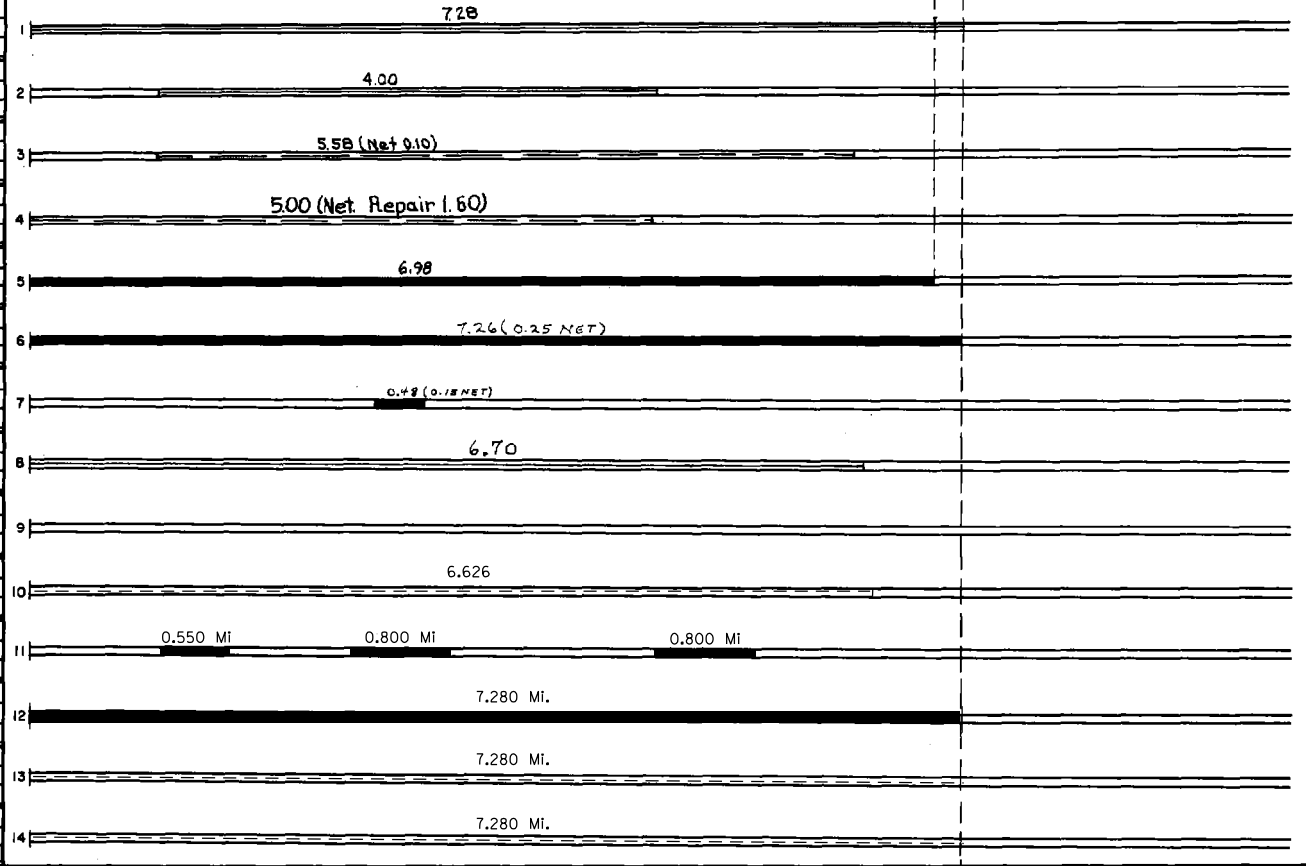

YEARS FROM TO		TOTAL MILES	UNINCORPORATED ROWY. MI. BR. MI.		INCORPORATED ROWY. MI. BR. MI.		RURAL ROWY. MI. BR. MI.		URBAN ROWY. MI. BR. MI.	

REMARKS: See Sheet No. 1

