

PREPARED BY  
HIGHWAY PLANNING SURVEY  
IN COOPERATION WITH  
U.S. PUBLIC ROADS ADMINISTRATION

STATE OF MINNESOTA  
DEPARTMENT OF HIGHWAYS  
ROAD LIFE STUDIES  
CONSTRUCTION PROJECT LOG RECORD

CONTROL SECTION 7910  
TRUNK HIGHWAY 60  
COUNTY Wabasha  
DISTRICT 6A

LIMITS: (In Wabasha) Jct. T.H. 61 - S. end of Wabasha-Nelson Bridge (Miss. River)

Ref. Pt. 218+00.172 - 219+00.225

Wabasha  
0.42 Mi.

PLAN

Wabasha-Nelson Bridge

Miss. River

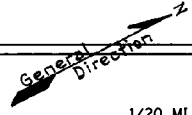

SCALE: 1" = 1/20 MI.

| YEAR BUILT | PROJECT N° | DESCRIPTION              |          |             | CODE N° |                                     |
|------------|------------|--------------------------|----------|-------------|---------|-------------------------------------|
|            |            | TYPE                     | WIDTH    | THICKNESS   |         |                                     |
|            |            | Mixed Bit.               | 24'      |             |         | No Record of Const. Added in 1945.  |
| M<br>1951  | A.F.E. 4   | Bit Surf. Repair         | 24'      |             |         | MC 3, 1073 Gal. Agg. 61 C.Y.        |
| M<br>1961  |            | Light Bit Seal           | 25'      |             |         | RC-2, 735 Gal. Agg. 28 C.Y.         |
| M<br>1963  |            | Light Bit Seal (Spots)   | 24'      |             |         | RC-2, 300 Gal. Agg. 16 C.Y.         |
| M<br>1965  | SF         | Light Bit Seal           | 24'      |             |         | Bit Mix 1922 Gal. FA-1 Agg. 42 C.Y. |
| M<br>1967  | SF         | Bit Surf. Repair         | 24' 3/4" |             |         | MC 250, 1364 Gal. Agg. 663 Tons     |
| C<br>1974  | -05        | Pl. Mix Bit Curb to Curb | 41' 3"   |             |         |                                     |
| C<br>1981  | 7910-08    | Grading Bit. Surfacing   | Var.     | 1 1/2' Var. |         | Spec. 2331 Spec. 2341               |
| M<br>1990  | SF         | Bit. Overlay             | 24'      | 1 1/2'      |         | Spec. 2341                          |
| M<br>1998  | 7910-14    | Milling Bit. Overlay     | Var.     | Var.        |         | Spec. 2350                          |

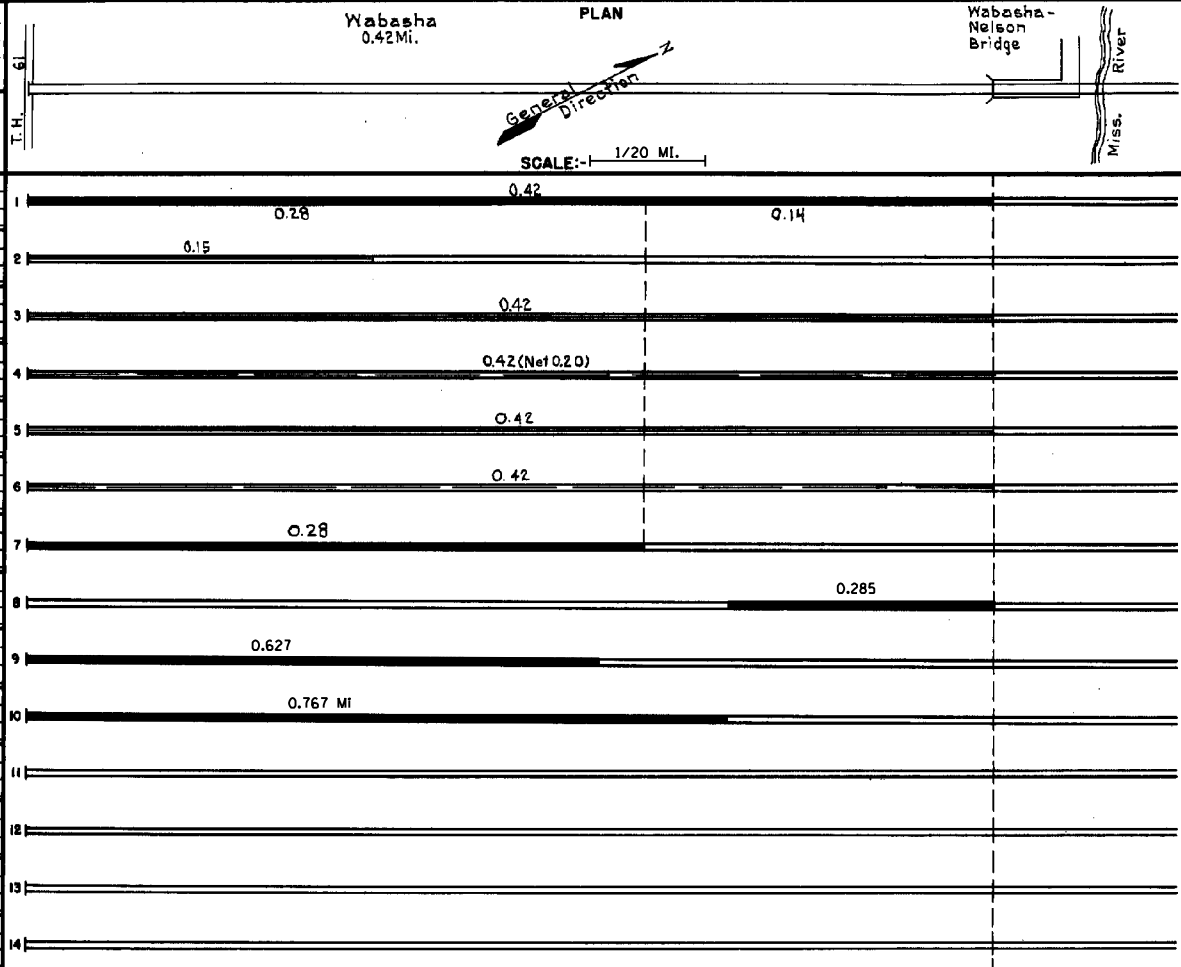

| YEARS |    | TOTAL MILES | UNINCORPORATED |         | INCORPORATED |         | RURAL     |         | URBAN     |         |
|-------|----|-------------|----------------|---------|--------------|---------|-----------|---------|-----------|---------|
| FROM  | TO |             | RDWY. MI.      | BR. MI. | RDWY. MI.    | BR. MI. | RDWY. MI. | BR. MI. | RDWY. MI. | BR. MI. |
| 1945  |    | 0.42        | 0.00           | 0.00    | 0.42         | 0.00    | 0.00      | 0.00    | 0.42      | 0.00    |

REMARKS: Layout is to scale as of 1945